

INFORMATION

SHICK TUBE-VEYOR CORPORATION'S full line of Auto-Jet Dust Collectors are designed to effectively separate pneumatic conveyed products from a pressure air stream. Dust infused air enters the unit and passes through a filter bag housing to the clean air plenum and then is expelled near the top of the unit. An electric timer sequentially activates valves which direct a concise burst of compressed air into the bags causing accumulated dust to be released from the bags and fall into the vessel. In addition to reducing facility maintenance requirements, Shick's Auto-Jet Dust Collector will help companies meet stringent air quality regulation and employee safety requirements. These Auto-Jet units are available in a wide range of bag lengths and filtering materials depending on material characteristics. Auto-Jet units can be mounted on a variety of storage vessels.



FEATURES

CLEAN AIR PLENUM - Includes mounting flange at tube sheet, lifting lugs, compressed air header with 1" pipe coupling for pressure gauge, 1" pipe coupling for plant air and 1/4" pipe coupling for drain, and diaphragm valves.

TIMER BOX - Includes pre-wired timer board with adjustable timer for 120 VAC, single phase, 60 hertz and includes solenoid valves. (Other voltages available upon request.)

BAG HOUSING - Equipped with mating flange at top and bottom, safety grate, and access door.

NEMA - 4 and 9 standard, 4X and 7 available.

MATERIAL OF CONSTRUCTION - 12 GA, ASTM 569 carbon steel or ASTM A240 304 stainless steel sheet metal (in material contact or all stainless options).

GAUGES - Supplied with a 0-200 p.s.i.g. gauge and pressure differential gauge (standard).

CARBON FINISHES - Internal welds are ground to a 36 grit finish on weld seams only. Internal finish is clear phenolic or epoxy. External paint is primed with white enamel finish coat.

STAINLESS STEEL FINISHES - Interior welds ground to a 80 grit finish with no cracks, pits or crevices, hard wheel finish on weld seams only. Exterior welds to be cleaned. Sheet is a 2B mill finish.



AUTO-JET DUST COLLECTORS

SHICK TUBE-VEYOR CORPORATION

4346 Clary Boulevard • Kansas City, Missouri 64130 • P (816) 861-7224 • F (816) 921-1901

Packaging - Processing
Bid on Equipment

1-847-854-8577

www.bid-on-equipment.com

SCHEMATICS

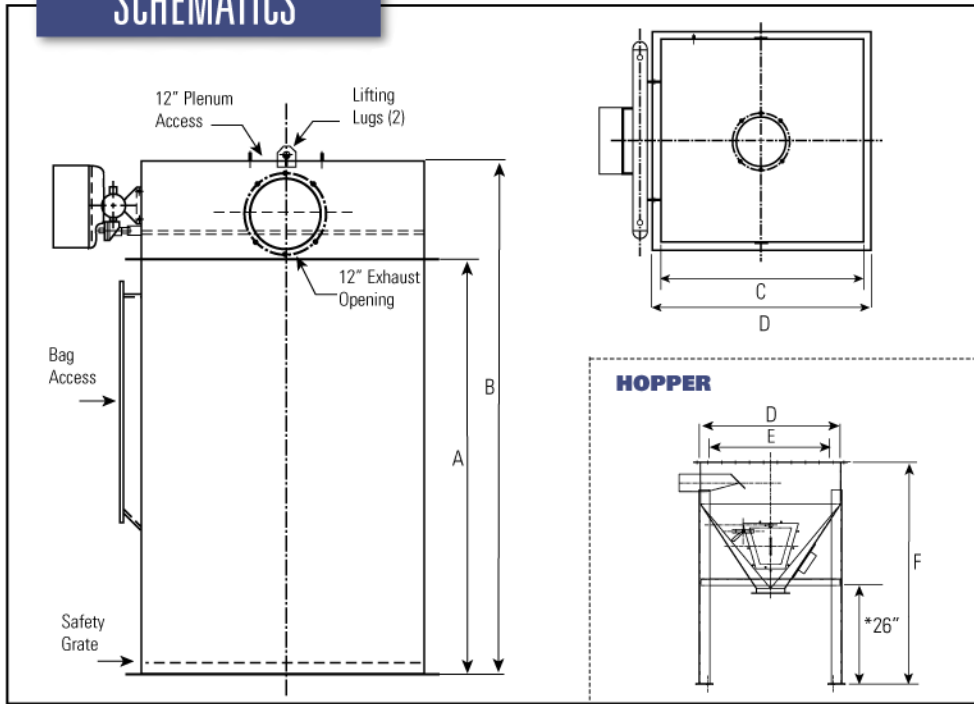

ATTACHMENTS

Consider the following attachments:

1. Hopper with legs
2. Air exhaust screen for outdoor/indoor applications
3. Flanged stub transition
4. Fan with bracket
5. Pressure differential switch

NOTES:

1. Dimension includes tubesheet thickness.
2. NEMA 9 units are shipped with polyester bags with stainless steel ground wire and metal bag cups.
3. Two bags units are not supplied with safety grates.
4. Bags, cages and clamps shipped separately for field installation.
5. Hopper is 60°.
6. AJ-36 Units and above are provided with double bag housing access doors.

OPTIONS FOR

BAGS:

- 16 oz. polyester (standard)
- 16 oz. polyester with ground wire
- 22 oz. polyester
- BHA Tex™ PTFE membrane

FINISH:

Stainless: 4B finish sheet with interior welds ground to a 150 grit finish.

DIMENSIONS - HOPPER

Model No.	C	D	F
AJ-9	24/610	28/711	49/1245
AJ-16	32/812	36/914	56/1422
AJ-25	40/1016	44/1117	63/1600
AJ-36	48/1219	52/1321	76/1930
AJ-49	56/1422	60/1524	83/2108
AJ-64	64/1626	68/1727	90/2286

* 26" height is based on 8" discharge and will vary with the size of the discharge.

DIMENSIONS - UNIT

Model No.	Cloth Area Sq. Ft.	No. of bags	Comp. Air Req'd (SCFM)	A inch/mm	B inch/mm	C inch/mm	D inch/mm	E inch/mm	Wt** Lb./Kg.
18AJ-2	4.5	2	3.0	29/737	43/1092	8/203	12/305	18/457	220/100
36AJ-2	9.0	2	3.5	47/1194	63/1600	8/203	12/305	18/457	260/118
36AJ-9	41	9	4.2	47/1194	63/1600	24/610	28/711	24/610	350/159
58AJ-9	66	9	4.5	69/1753	84/2134	24/610	28/711	24/610	450/204
84AJ-9	95	9	5.0	96/2438	112/2845	24/610	28/711	24/610	525/238
36AJ-16	72	16	5.5	47/1194	63/1600	32/813	36/914	32/813	500/227
58AJ-16	116	16	5.8	69/1753	85/2159	32/813	36/914	32/813	625/283
84AJ-16	168	16	6.2	96/2438	112/2845	32/813	36/914	32/813	750/340
36AJ-25	112	25	6.5	47/1194	63/1600	40/1016	44/1118	40/1016	650/295
58AJ-25	182	25	6.7	69/1753	85/2159	40/1016	44/1118	40/1016	800/363
84AJ-25	263	25	7.0	96/2438	112/2845	40/1016	44/1118	40/1016	875/442
36AJ-36	163	36	7.5	47/1194	63/1600	48/1219	52/1321	48/1219	850/386
58AJ-36	262	36	8.0	69/1753	85/2159	48/1219	52/1321	48/1219	925/420
84AJ-36	379	36	8.5	96/2438	112/2845	48/1219	52/1321	48/1219	1000/454
36AJ-49	221	49	8.5	47/1194	63/1600	56/1422	60/1524	56/1422	980/444
58AJ-49	356	49	9.0	69/1753	85/2159	56/1422	60/1524	56/1422	1075/488
84AJ-49	516	49	9.5	96/2438	112/2845	56/1422	60/1524	56/1422	1150/522
36AJ-64	289	64	10.0	47/1194	63/1600	64/1626	68/1727	64/1626	1120/508
58AJ-64	465	64	11.0	69/1753	85/2159	64/1626	68/1727	64/1626	1280/580
84AJ-64	674	64	11.5	96/2438	112/2845	64/1626	68/1727	64/1626	1400/635

** All weights are for carbon steel units and are nominal.

HEADQUARTERS:

Shick Tube-Veyor Corporation
4346 Clary Boulevard, Kansas City, MO 64130
P (816) 861-7224 / F (816) 921-1901

Shick Tube-Veyor Asia Pacific PTE LTD
32 Ang Mo Kio Industrial Park 2
#02-03 Sing Industrial Complex, Singapore 569510
Tel: (65) 4824600 Fax: (65) 4818255

Information on this page is subject to change without notice. For additional information on this and other Shick Tube-Veyor products and services, please call Shick directly or your local representative.

REPRESENTED BY:

Packaging - Processing
Bid on Equipment
1-847-854-8577
www.bid-on-equipment.com



SHICK TUBE-VEYOR CORPORATION

AJT K96 10K