



## Preparation Table Side Mount Saladtop models 9200-32-7

model  9210-32-7  9200-32-7  9230-32-7  9220-32-7

### Description:

Randell mullion blower coil, with thermostatic control, cools pans and/or base, and allows for use of full depth interiors. R-134a expansion valve refrigeration system in refrigerators are CFC free. Units with durable shelf supports molded into sides, lift-off louver, condensate evaporator, "CFC free" foamed in place insulation and 6" high adjustable legs. Cordset for 115V operation.

### Specifications:

**CABINET EXTERIOR:** Cabinet body is constructed of all metal. The top, front, sides and louver panel are stainless steel. Bottom & back of unit are corrosion resistant steel. Saladtop refrigerator to have top cutout with sanitary raised rim and recessed adaptor. Hinged, stainless steel roll-cover. Full length, NSF composition 12" cutting board provided.

**CABINET INTERIOR:** Interior of cabinet is fully coved to meet N.S.F. standard #7. The Interior bottom, back, and top are anodized aluminum with coved corners for easy clean-up. The interior ends are ABS. Shelf supports molded into sides. Unit insulated with a minimum of 2.5" of CFC free, foamed in place polyurethane.

**DOORS:** Stainless steel front with easy to grasp recessed handles, mounted on heavy duty concealed hinges. Hinges are all stainless steel with bronze pivot pin in nylon bushing. Doors with foamed in place insulation, press fit magnetic gaskets - (designed for installation & removal without tools), and deep draw ABS interior liner for maximum insulation value.

**REFRIGERATION:** Refrigerators utilize a CFC free, R-134a Expansion Valve refrigeration system that includes condensing unit, and thermostatic control for operator adjustability. Compressor housing to allow maximum airflow and permit mounting of standard hot gas condensate evaporator. Mullion coil, is coated to resist corrosion, and offers maximum air flow.

This equipment is intended for use in rooms having an ambient temperature of 86°F (30°C) or less.

model 9200-32-7 shown



### Standard Features:

- Side mounted compressor with mullion "Turbo" coil provides proper pan cooling, and "full depth" usable interior space
- R-134a refrigerant in refrigerators and R-404a in freezers both are "CFC free"
- Exterior stainless steel top & front
- Foamed in place "CFC free" urethane insulation
- Self-closing doors with exclusive press-fit magnetic gaskets
- Shelf supports molded into sides
- Expansion valve
- Condensate evaporator
- Cord and plug for 115 volt operation
- 6" high adjustable legs
- Full length NSF approved 12" wide composition cutting board
- Stainless steel roll cover

### Options & Accessories:

- Stainless steel back panel
- Refrigerated drawers
- Tray racks for 24" or 27" openings only
- Overshelves
- Casters
- Export voltages available

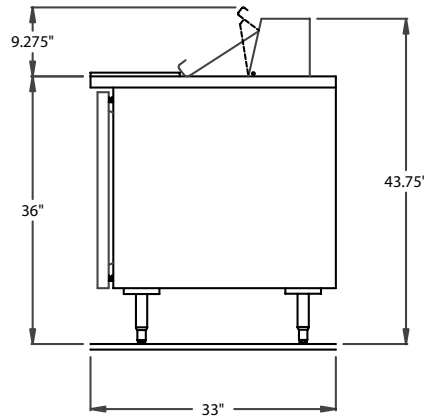
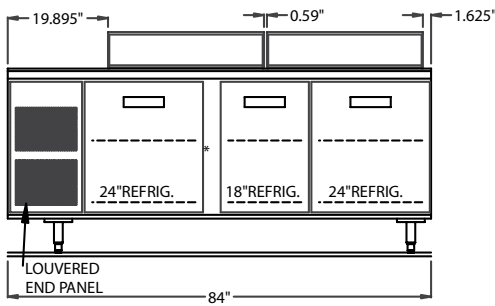
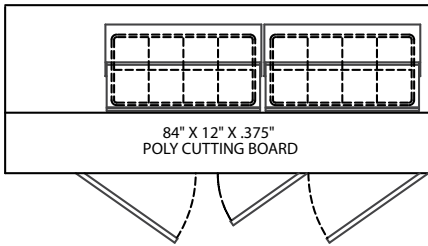
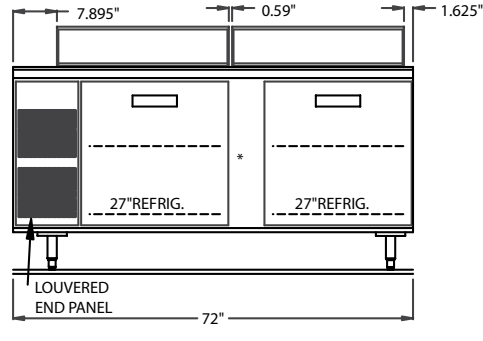
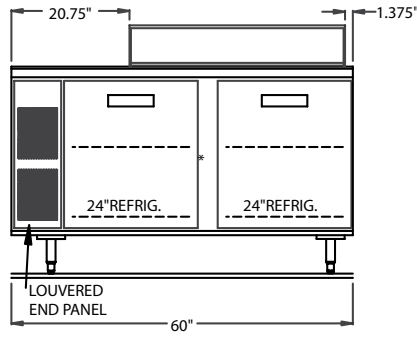
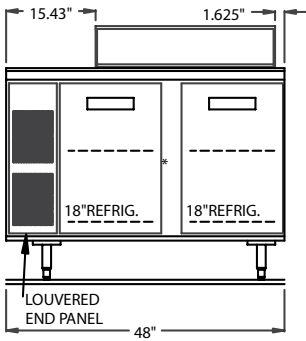
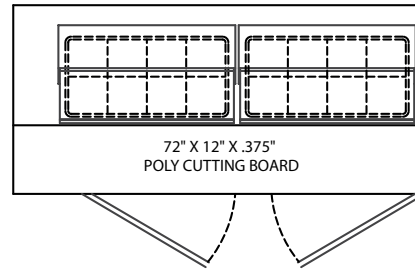
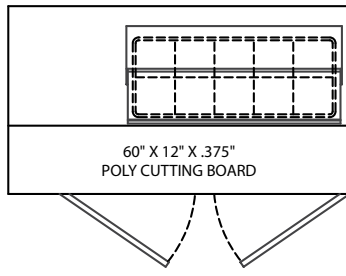
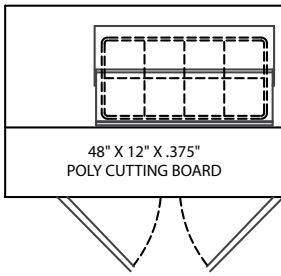

Drawings are to be viewed in the same order as the chart, one drawing to represent refrigerator and freezer units

**NOTE:** When ordering casters, 6" casters equal 35" height; 4" casters equal 33" height

Model	L	D	H	Doors	Storage Cu. Ft.	Pan Capacity	HP	Volt	Amps	NEMA	Ship Wt.
9210-32-7	48"	33"	36"	(2)18"	12.2	(8)1/6 or (4)1/3	1/3	115/60/1	9	5-15P	325
9200-32-7	60"	33"	36"	(2)24"	16.5	(10)1/6 or (5)1/3	1/3	115/60/1	9	5-15P	420
9230-32-7	72"	33"	36"	(2)27"	19.8	(16)1/6 or (8)1/3	3/8	115/60/1	9	5-15P	450
9220-32-7	84"	33"	36"	(2)24", (1)18"	20.6	(16)1/6 or (8)1/3	3/8	115/60/1	9	5-15P	500