



Custom Remote Recessed Coldwall Refrigerator models 53000PO

model 53333PO 53336PO 53339PO 53348PO 53351PO 53354PO 53357PO
 53360PO 53369PO 53372PO 53375PO 53378PO 53381PO 53387PO
 533102PO 533114PO

Description:

Remote refrigerator storage units with mechanically cooled pan opening. These units are offered in variety of lengths to meet your specific base storage or pan storage requirements. The mechanically cooled pan opening uses Randell's exclusive design technologies, such as our Exclusive Refrigerated Pan Opening Thermostat allowing customers to make adjustments to the opening temperatures (independent of the base).

Specifications:

CABINET EXTERIOR: Top to be one piece of die-formed 16 gauge stainless steel with 2 1/2" nosing. Backsplash to be coved cornered, with 45° return at top and overall height of 6 3/4". Ends at top fitted with recessed heavy duty steel bars for field bolting units together, producing a hairline seam. Exterior body to be corrosion resistant steel. Door opening frames are ABS and contain magnetic strip for positive seal of door gaskets. Work surface to be at 36" work height. Legs to be 6" high stainless steel with adjustable bullet foot. Legs mounted to full length channel frame assembly which is integrally welded to bottom of body assembly. Legs can be moved left to right to avoid floor obstacles during installation.

CABINET INTERIOR: Base interior to be ABS thermoplastic at ends only. Stainless steel interior liner to be coved cornered to form bottom, back and top. Unit insulation to be CFC free foamed in place urethane.

DOORS: Door fronts to be 22-gauge stainless steel exterior front with 16 gauge stainless steel door pulls/handles. The interior liner is vacuumed formed ABS with integral gasket retainer for easy cleaning and accepts Randell's Exclusive Press Fit Gasket System. Doors are mounted on concealed hinges.

REFRIGERATION: Refrigerant to be specified by customer (Specification based on R-404a refrigerant). System is a balanced heavy duty system set-up to accept hook-up to a single compressor system. The base is cooled by an independent blower coiled operating on its own expansion valve and thermostat and operates through a dedicated solenoid valve. The pan opening is provided with its own thermostat (located in the compressor housing) making it easily adjustable for specific ambient conditions without effecting the balance of the system. An on/off switch for the pan opening is provided. Optional electric condensate evaporator.

model 53354PO shown with optional finished end



Standard Features:

- Low profile 2" recess pan design provides easy reach and optimal pan temperatures & reliability
- Full Length Poly Cutting Board
- Front breathing compressor housing with directed air flow- Randell Exclusive
- Easy maintenance Press-Fit gaskets- A Randell Exclusive
- Pan opening thermostat- A Randell Exclusive
- Drain in pan opening for easy cleaning
- Hinged Removable stainless steel covers
- Foamed in place urethane insulation providing superior insulation and durability
- 6" high adjustable legs, moveable left to right if needed
- Available up to 16' under one common assembly
- Adapter bars are standard to accommodate a compliment of 1/6 size pans

Options & Accessories:

- Hinged slide-back covers
- Lift-off (removable) night covers
- Stainless Steel Ends
- Stainless Steel Back
- Laminate fronts, ends and back options
- Casters in lieu of legs
- Export voltages
- Over-shelving storage options
- Wide pan opening

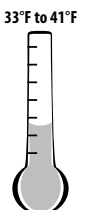

53000PO SERIES REMOTE REFRIGERATORS WITH STANDARD DEPTH RECESSED PAN OPENING

| | | | | | | | | | |
|------------------------------|------------|------------------------|------------------------|------------------------|-------------------|------------|------------------|------------|-------------|
| Length | 33" | 36" | 39" | 48" | 51" | 54" | 57" | 60" | 69" |
| Model 33" | 53333PO | 53336PO | 53339PO | 53348PO | 53351PO | 53354PO | 53357PO | 53360PO | 53369PO |
| # of doors (6" mech.) | (1) 21" | (1) 24" + 6" coil hsg. | (1) 27" + 6" coil hsg. | (2) 21" + 6" coil hsg. | ((1) 21", (1) 24" | (2) 24" | (1) 24", (1) 27" | (2) 27" | (3) 21" |
| # Pans | (6) 1/6 | (6-8) 1/6 | (6-8) 1/6 | (6-12) 1/6 | (6-12) 1/6 | (6-12) 1/6 | (8-14) 1/6 | (8-14) 1/6 | (10-18) 1/6 |
| Min. Length of Opening | 27" | 27" | 27" | 27" | 27" | 27" | 34" | 34" | 41" |
| Storage Cu. Ft. | 4.31 | 4.99 | 5.67 | 7.71 | 8.39 | 9.07 | 9.75 | 10.43 | 12.47 |
| Cutting Board Width | 10" | 10" | 10" | 10" | 10" | 10" | 10" | 10" | 10" |
| Recommended H.P./Refrigerant | 1/3hp/404a | 1/3hp/404a | 1/3hp/404a | 1/3hp/404a | 1/3hp/404a | 1/3hp/404a | 1/3hp/404a | 1/3hp/404a | 1/2hp/404a |
| Amps | 5.0 | 5.0 | 5.0 | 5.0 | 5.0 | 5.0 | 5.0 | 5.0 | 5.0 |
| Volt/Cycle/Phase | 115/60/1 | 115/60/1 | 115/60/1 | 115/60/1 | 115/60/1 | 115/60/1 | 115/60/1 | 115/60/1 | 115/60/1 |
| Ship Wt. - lbs. | 352 | 369 | 385 | 418 | 435 | 451 | 479 | 495 | 545 |
| BTU Design load* | 302/437 | 302/473 | 378/509 | 454/744 | 454/780 | 529/815 | 529/851 | 605/887 | 680/1222 |
| Evap BTU/TD *Opening/Base | 13/120 | 16/120 | 19/120 | 22/120 | 22/120 | 25/120 | 25/100 | 27/180 | 30/120 |

| | | | | | | | |
|------------------------------|------------------|------------------|-------------|------------------|-------------|-------------|-------------|
| Length | 72" | 75" | 78" | 81" | 87" | 102" | 114" |
| Model 33" | 53372PO | 53375PO | 53378PO | 53381PO | 53387PO | 533102PO | 533114PO |
| # of doors (9" mech.) | (2) 21", (1) 24" | (2) 24", (1) 21" | (3) 24" | (2) 24", (1) 27" | (3) 27" | (4) 24" | (4) 27" |
| # Pans | (10-18) 1/6 | (10-18) 1/6 | (10-18) 1/6 | (10-18) 1/6 | (12-20) 1/6 | (14-24) 1/6 | (14-26) 1/6 |
| Min. Length of Opening | 41" | 41" | 41" | 41" | 48" | 55" | 55" |
| Storage Cu. Ft. | 13.15 | 13.83 | 14.51 | 15.19 | 16.55 | 16.43 | 17.86 |
| Cutting Board Width | 10" | 10" | 10" | 10" | 10" | 10" | 10" |
| Recommended H.P./Refrigerant | 1/2hp/404a | 1/2hp/404a | 1/2hp/404a | 1/2hp/404a | 1/2hp/404a | 5/8hp/404a | 3/4hp/404a |
| Amps | 5.0 | 5.0 | 5.0 | 5.0 | 5.0 | 5.0 | 5.0 |
| Volt/Cycle/Phase | 115/60/1 | 115/60/1 | 115/60/1 | 115/60/1 | 115/60/1 | 115/60/1 | 115/60/1 |
| Ship Wt. - lbs. | 561 | 589 | 605 | 622 | 655 | 721 | 770 |
| BTU Design load* | 680/1158 | 756/1193 | 756/1229 | 832/1265 | 832/1336 | 1058/1643 | 1134/1786 |
| Evap BTU/TD *Opening/Base | 30/120 | 33/120 | 33/120 | 36/240 | 36/240 | 44/240 | 47/240 |

NOTE:

Pan capacity reflected is the actual amount of pans that are clearly accessible by the operator. Units with multiple covers may actually have additional pan capacity that is partially obstructed by the cover divider/mullion. Remote pan openings intended to be connected to separate low-temp system, can be as small as (6) pans on any size base.

*BTU load and capacity ratings based on 100F ambient plus 30% for usage and product loading in base. Final system selection should consider usage requirements and combined loads. Recommended HP applied to self-contained (single) unit of equal storage capacity; increased HP may be appropriate in some remote applications.

Evaporator BTU/TD reflects NSF refrigerated base requirements when base is provided with +20F system separate from -10F pan opening system.



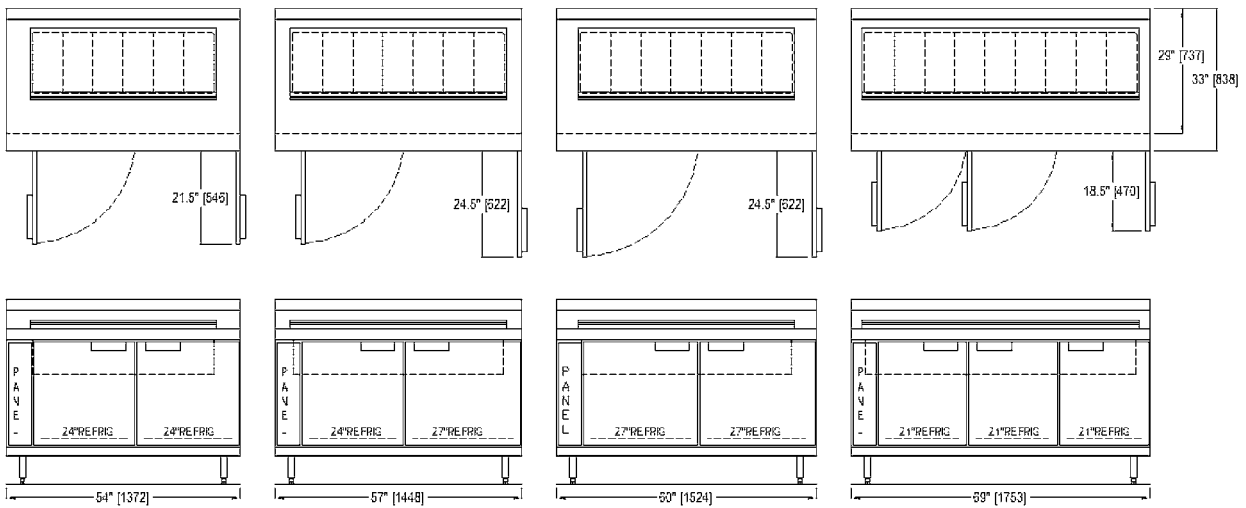
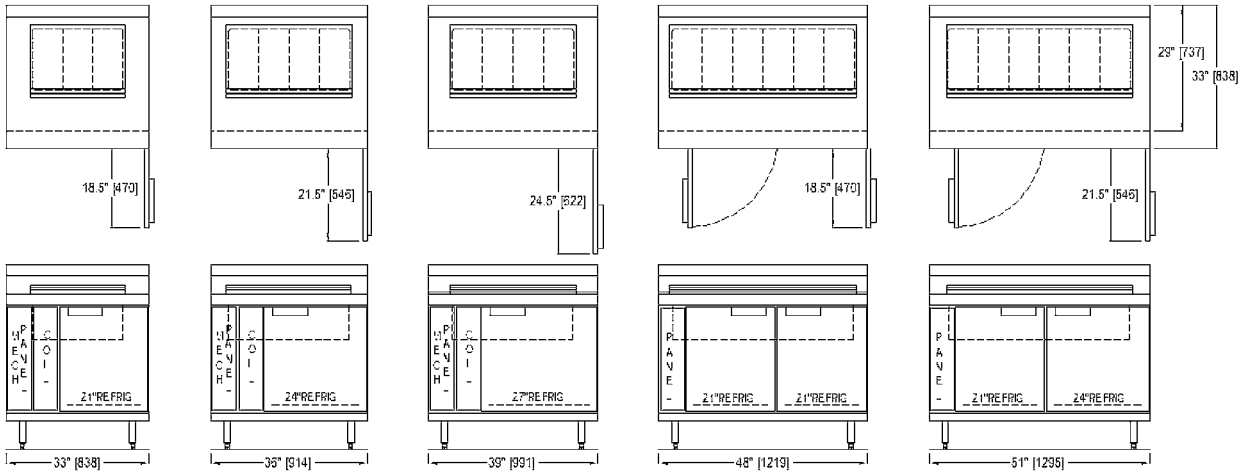

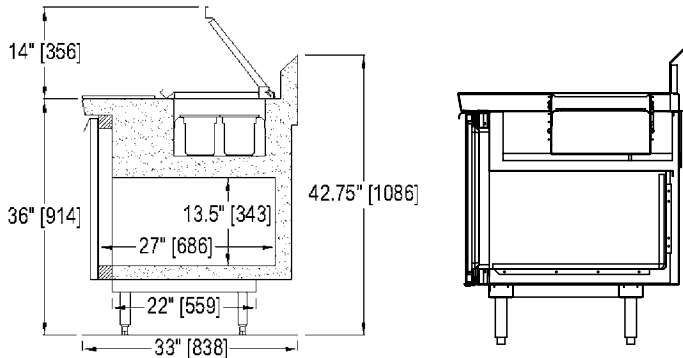
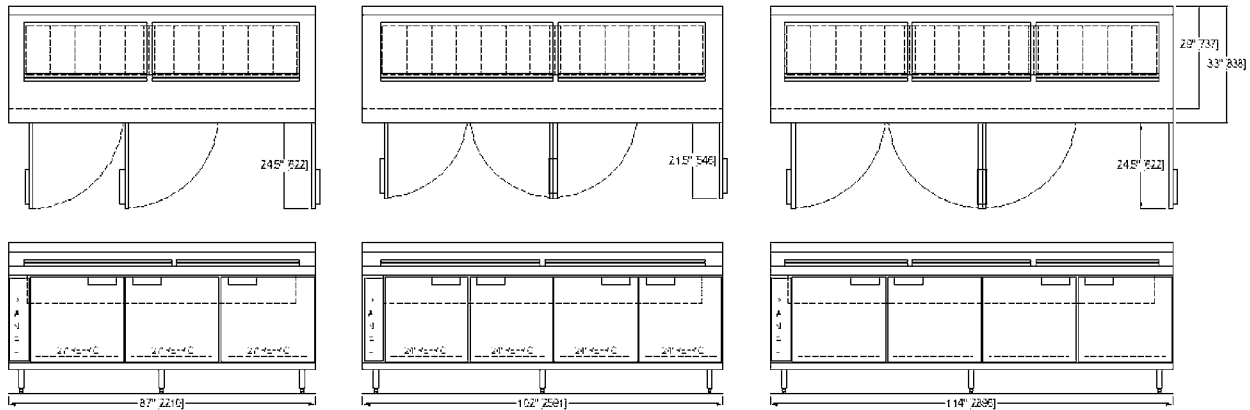
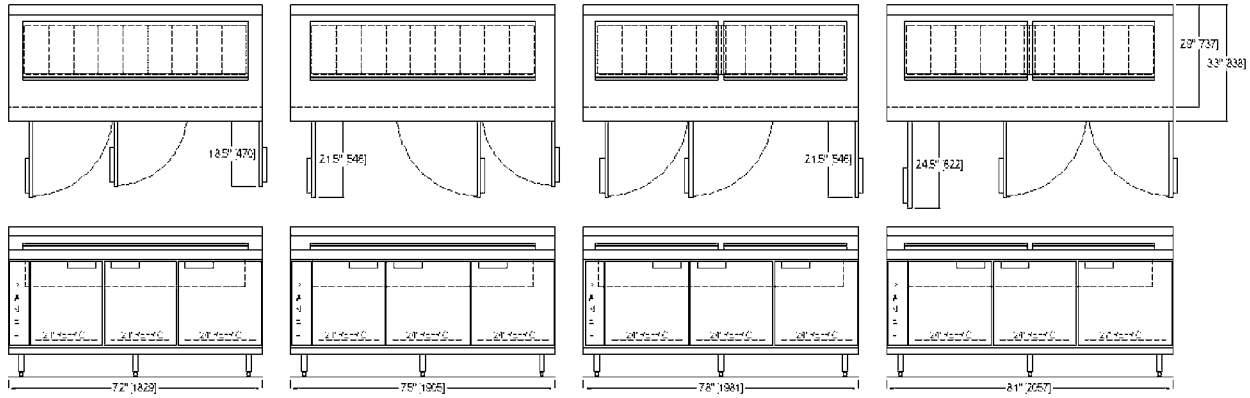

SECTION VIEW

DOOR OPENING SIZES - INTERIOR DEPTHS

| Door Width | Clearances Through Door | | Interior Depth Behind Door (unit depths in parentheses) |
|------------|-------------------------|---------------|--|
| | Lt. to Rt. | Top to Bottom | |
| 18" | 13 1/4" | 13 1/2" | (33")-26" (29")-22" (22")-15.5" |
| 21" | 16 1/4" | 13 1/2" | (33")-26" (29")-22" (22")-15.5" |
| 24" | 19 1/4" | 13 1/2" | (33")-26" (29")-22" (22")-15.5" |
| 27" | 22 1/4" | 13 1/2" | (33")-26" (29")-22" (22")-15.5" |

• Shelf depth is 25 1/4" on 33" deep equipment, 21 1/4" on 29" deep equipment, and 14 1/2" on 22" deep equipment.

