



# Display Merchandiser Refrigerated Curved Glass models 4100DT

model  4137DT  4149DT

## Description:

Dual section, refrigerated display case with tempered/insulated curved glass front. The ambient section is located above the refrigerated section and features removable sliding doors that allow easy access. The refrigerated section features insulated, self-closing doors, adjustable display shelves, and a stainless steel interior bottom. Separation of sections is achieved by the use of a 3/4" thick, tempered/insulated thermal glass display shelf. Fluorescent light from three fixtures located through out the case provide a bright environment for product display. Self-contained, R-134a forced air refrigeration system with high capacity evaporator coil and thermostatic control. Foamed in place, "CFC free" insulation and cordset for 115V operation. Stainless steel exterior finish is standard.

## Specifications:

**CABINET EXTERIOR:** Exterior base features stainless steel finish with louvered panel to provide proper air flow to condensing unit. Unit sides to be stainless steel - standard, (lamine ends are optional). Unit top features 15 1/2" wide, full length stainless steel shelf / work area. Fixed curved glass front to be tempered for safety, and insulated to prevent condensation. Glass perimeter heated to prevent condensation. Ambient section is located in door section.

**CABINET INTERIOR:** Interior to have stainless steel bottom with adjustable wire shelving supports. Each unit comes complete with a heavy gauge, powder coated wire shelf in the refrigerated section, easily removable for cleaning. 3 shielded, full length, fluorescent lights are provided. Two lights are permanently mounted to interior, while the other one is moveable/removable, and supported by the shelving set-up. Mirrored interior ends are standard. Unit insulated with CFC free, foamed in place urethane insulation. Separation of the two temperature sections is achieved by the use of a 3/4" thick, tempered/insulated thermal glass display shelf.

**DOORS:** Refrigeration section has (2) removable, insulated, sliding glass doors that are self-closing on ball bearings riding in nylon track for smooth operation. Rubber wiper between doors to minimize air loss, and vinyl frame to reduce condensation. Door locking system is standard. Doors are easily removed for cleaning. Ambient section has two removable non-insulated sliding Lexan doors mounted in a stainless steel track.

**REFRIGERATION:** CFC free, R-134a refrigeration system with condensing unit, high capacity evaporator blower coil, condensate evaporator, and thermostatic control for operator adjustability.

model 4137DT shown



Unit totally prewired and to be supplied with 8' cordset (NEMA 5-15P) for 115V plug-in operation. (Cordset can be accessed thru either end of unit, thru openings in base).

## Standard Features:

- Self-contained, forced air refrigeration system with thermostatic control, system utilizes "CFC free", R-134a refrigerant
- Refrigerated/ambient dual temperature display merchandiser
- Mirrored interior ends
- (2) light fixtures
- Tempered/insulated curved glass front
- Complete adjustable shelving & interior lighting system
- Insulated glass sliding glass doors on refrigeration section are removable, self-closing, riding in nylon track, with lock
- Ambient section with sliding doors located above refrigerated section
- Tempered/insulated thermal glass display shelf
- Foamed in place "CFC free" urethane insulation
- Stainless steel finish is standard, any standard laminate is available
- Cord & Plug for 115V operation

## Options & Accessories:

- Laminate Finish
- Glass Shelf
- Export Voltages

33°F to 40°F

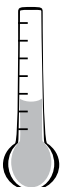

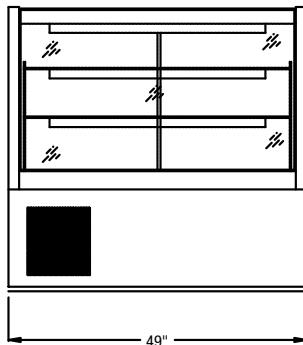
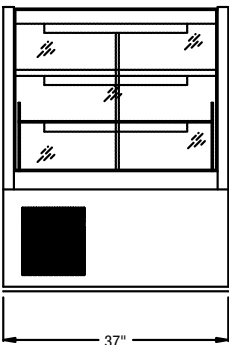
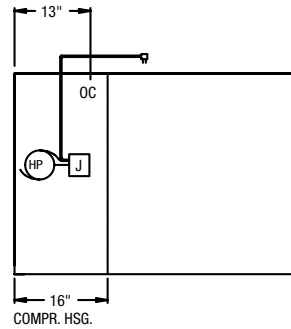
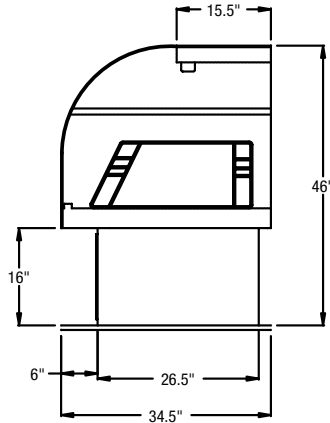
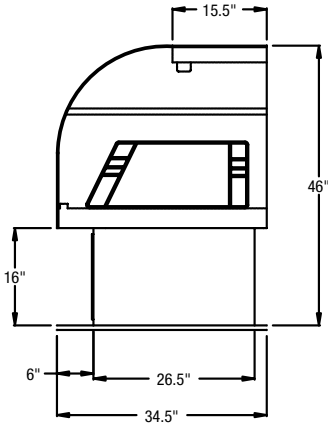
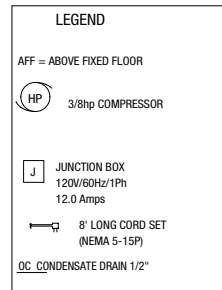
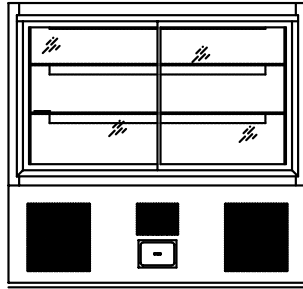
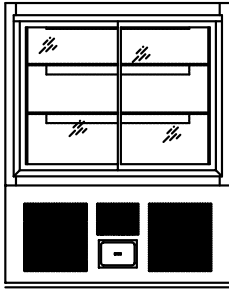

Drawings are to be viewed in the same order as the chart

Unit Length	Curved Glass Display Case Door Opening Sizes - Interior Depths		Interior Depth Behind Sliding Glass Doors
	Clearances Through Door Lt. to Rt.	Clearances Through Door Top to Bottom	
37"	13"	15"	27" *
49"	19"	15"	27" *

\* Clear interior depth at adjustable shelf levels and lower cavity.

Models	Display Area			Shelves Sq. Ft.*	Hp.	Volt	Amp.	NEMA	Wt.
	L	D	H						
4137DT	37"	35"	46.5"	16.2	1/3	115/60/1	10	5-15P	500
4149DT	49"	35"	46.5"	24.3	3/8	115/60/1	12	5-15P	560

\* Includes interior bottom.