



Display Merchandiser Refrigerated Curved Glass models 4100A

- model self-contained 4137SCA 4149SCA 4161SCA 4173SCA
- remote 4137REA 4149REA 4161REA 4173REA
- dry 4137DR 4149DR 4161DR 4173DR

Description:

Self-contained refrigerated curved glass display case with insulated, self-closing doors, adjustable display shelves, insulated glass front, and fluorescent illumination. R-134a forced air refrigeration system with high capacity evaporator coil and thermostatic control. Foamed in place, "CFC free" insulation and cordset for 115V operation. Stainless steel exterior finish is standard. Available as a remote or dry unit.

Specifications:

CABINET EXTERIOR: Exterior base features stainless steel finish with louvered panel to provide proper air flow to condensing unit. Unit sides to be stainless steel - standard, (lamine ends are optional). Unit top features 15 1/2" wide, full length stainless steel shelf / work area. Fixed curved glass front to be tempered for safety, and insulated to prevent condensation. Glass perimeter heated to prevent condensation.

CABINET INTERIOR: Interior to have stainless steel bottom with adjustable wire shelving supports. Each unit comes complete with a full complement of heavy gauge, powder coated wire shelves easily removable for cleaning. 3 shielded, full length, fluorescent lights are provided. One light is permanently mounted to interior top, while the other two are removable, and supported by the shelving set-up. Mirrored plastic interior ends are standard. Unit insulated with CFC free, foamed in place urethane insulation.

DOORS: (2) removable, insulated glass sliding glass doors are self-closing on ball bearings riding in nylon track for smooth operation. Rubber wiper between doors to minimize air loss, and vinyl frame to reduce condensation. Door locking system is standard. Doors are easily removed for cleaning.

REFRIGERATION: CFC free, HFC-134a refrigeration system with condensing unit, high capacity evaporator blower coil, condensate evaporator, and thermostatic control for operator adjustability. Unit totally prewired and to be supplied with 8' cordset (NEMA 5-15P) for 115V plug-in operation. (Cordset can be accessed thru either end of unit, thru openings in base).

REMOTE MODELS Same as above, except condensing unit to be provided by others.

DRY MODELS Ambient room temperature display case.

model 4137SCA shown
(shown with optional glass shelves & mirrored stainless steel trim)



Standard Features:

- Self-contained, forced air refrigeration system with thermostatic control, system utilizes "CFC free", R-134a refrigerant
- Available as a remote or dry unit
- Insulated glass sliding glass doors are removable, self-closing, riding in nylon track, with lock
- Tempered / insulated curved glass front
- Complete adjustable shelving & light system
- Foamed in place "CFC free" urethane insulation
- Available in stainless steel finish (standard), or any optional standard laminate
- Cord & Plug for 115V operation
- Mirrored interior ends
- (3) light fixtures
- Hot gas condensate evaporator

33°F to 40°F

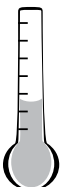

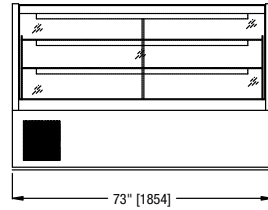
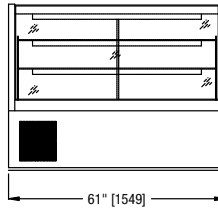
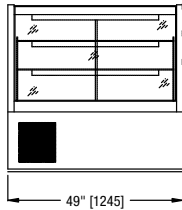
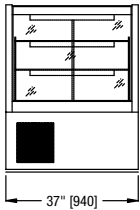
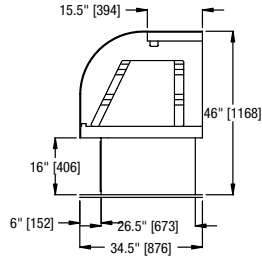
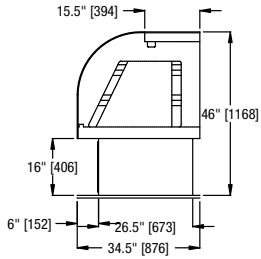
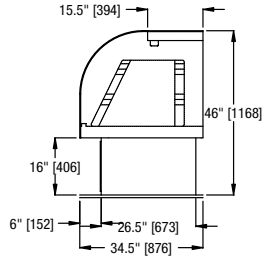
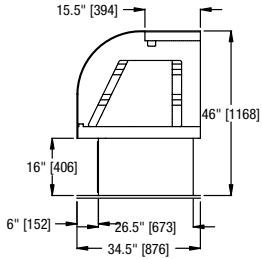
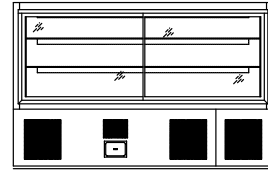
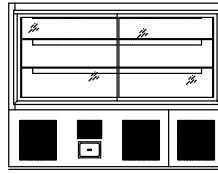
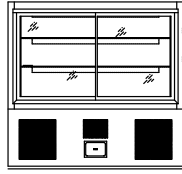
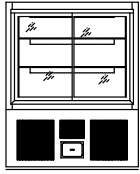

MODEL # 4137SCA

MODEL # 4149SCA

MODEL # 4161SCA

MODEL # 4173SCA

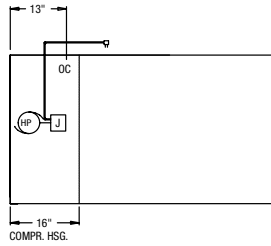
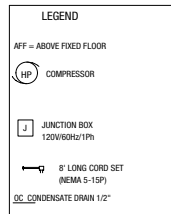

Drawings are to be viewed in the same order as the chart



Curved Glass Display Case Door Opening Sizes - Interior Depths			
Unit Length	Clearances Through Door		Interior Depth Behind Sliding Glass Doors
	Lt. to Rt.	Top to Bottom	
37"	13"	22"	27" *
49"	19"	22"	27" *
61"	25"	22"	27" *
73"	31"	22"	27" *

* Clear interior depth at all shelf levels. Top shelf normally provided with 21" depth - 26" deep shelf provided for bottom shelf, available for top as well.

Self-Contained Models	L	D	H	Display Area Shelves Sq. Ft.*	Hp.	Volt	Amp.	NEMA	WT.
4137SCA	37"	34.5"	46"	16.4	1/3	115/60/1	10	5-15P	500
4149SCA	49"	34.5"	46"	22.6	3/8	115/60/1	12	5-15P	560
4161SCA	61"	34.5"	46"	29	1/2	115/60/1	12	5-15P	675
4173SCA	73"	34.5"	46"	35.2	1/2	115/60/1	15.6	5-20P	805
Remote Models					Rec. Hp.				
4137RE	37"	34.5"	46"	16.4	3/8	115/60/1	5	5-15P	400
4149 RE	49"	34.5"	46"	22.6	1/2	115/60/1	5	5-15P	460
4161 RE	61"	34.5"	46"	29	1/2	115/60/1	5	5-15P	575
4173 RE	73"	34.5"	46"	35.2	3/4	115/60/1	5	5-15P	705
Dry Models									
4137DR	37"	34.5"	46"	16.4	N / A	115/60/1	4	5-15P	400
4149 DR	49"	34.5"	46"	22.6	N / A	115/60/1	4	5-15P	360
4161 DR	61"	34.5"	46"	29	N / A	115/60/1	4	5-15P	475
4173 DR	73"	34.5"	46"	35.2	N / A	115/60/1	4	5-15P	605

* Includes interior bottom

