

Custom SC Refrigerated Chef Stand models 25000

model 25348 25366 25378 25384 25396 253102 253114

Description:

Self-contained, CFC free, refrigerated cooking equipment stand with reinforced stainless steel equipment shelf. Integral backsplash with 45° return. Refrigerated drawers on 16 gauge stainless steel tracks with 1 5/8" stainless steel bearings and removable plastic pan. 6" high adjustable legs.

Specifications:

EQUIPMENT SHELF: Equipment shelf to be one piece of die-formed stainless steel with 2" nosing and marine edge. Shelf is reinforced with welded channel brace assembly.

UNIT BODY: Body ends to be die-formed stainless steel, finished and polished on the inside, with corrosion resistant exterior. Ends at top fitted with recessed heavy duty steel bars for splining units together, producing a hairline seam. Backsplash to be covered cornered, with 45° return at top and overall height of 6 3/4". (If fitted with vent system, standard backsplash to be omitted and unit fitted with 3" thick backsplash to meet NFPA 96). 10" wide x 1 1/4" thick laminated maple cutting board provided with removable supports. Base interior to be ABS thermoplastic at ends only. Stainless steel interior liner to be covered cornered to form bottom, back and top. Unit insulated with CFC free, high density polyurethane expanding foam. Legs to be 6" high stainless steel, with adjustable bullet foot. Legs mounted to full length channel frame assembly which is integrally welded to bottom of assembly. Legs can be moved left to right to avoid floor obstacles during installation.

DRAWERS: Self-contained refrigerated drawers are located below equipment shelf. Drawer liners are plastic, removable without tools, with drawer tracks of 16 gauge stainless steel with 1 5/8" stainless steel bearings, self-closing. Drawer opening frame to be ABS and contain magnetic strip for positive sealing of gaskets. Drawer fronts to be 22 gauge stainless steel with 16 gauge stainless steel handles, magnetic gaskets, and plastic pan.

REFRIGERATION: Interior fitted with Randell R-134a evaporator blower coil for cooling base. Blower coil fitted with expansion valve for fast recovery and thermostatic control for field adjustability. Condensing unit sized and installed for proper cooling. Units totally prewired and to be supplied with 8' cordset (NEMA 5-15P) for 115 volt operation. Hot gas condensate evaporator to be installed in compressor airflow.

Shown with optional finished end.



Standard Features:

- Available under one piece top with other modular equipment up to 16' in length
- 6" high legs—adjustable and movable
- 10" wide x 1 1/4" thick laminated maple work board
- Self-closing drawers with removable plastic pan
- Self-contained refrigeration system features expansion valve for fast recovery, and thermostatic control for field adjustability, R-134a refrigerant, CFC free
- If unit is fitted with vent, then backsplash will be 3" thick to meet NFPA 96
- 45° integral stainless backsplash is standard. 90° stainless steel backsplash is optional.
- Equipment Rails are optional

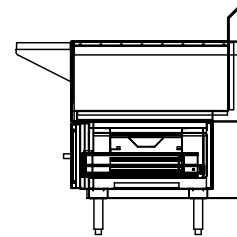
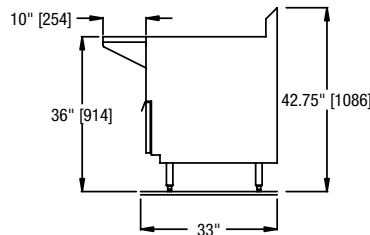
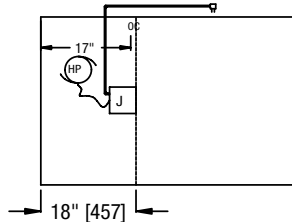
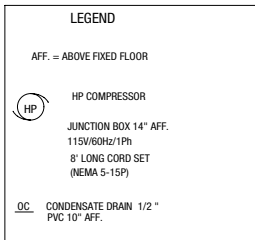

SECTION VIEW

29" Deep Equipment

Length	48"	66"	78"	84"	96"	102"	114"
Height*	36"	36"	36"	36"	36"	36"	36"
Drawers	(1) 24"	(1) 18" (1) 24"	(3) 18"	(2) 18" (1) 24"	(3) 24"	(3) 24"	(2) 18" (1) 24"
H.P.	1/4	1/4	1/4	1/4	1/4	1/3	1/3
Volts	115/60/1	115/60/1	115/60/1	115/60/1	115/60/1	115/60/1	115/60/1
Amps	6	6	6	6	6	7.5	7.5
NEMA	5-15P	5-15P	5-15P	5-15P	5-15P	5-15P	5-15P
Ship Wt.	293 lbs.	425 lbs.	513 lbs.	558 lbs.	631 lbs.	661 lbs.	734 lbs.

33" Deep Equipment

Length	48"	66"	78"	84"	96"	102"	114"
Model No.	25348	25366	25378	25384	25396	253102	253114
Height*	36"	36"	36"	36"	36"	36"	36"
Drawers	(1) 24"	(1) 18" (1) 24"	(3) 18"	(2) 18" (1) 24"	(3) 24"	(3) 24"	(2) 18" (1) 24"
H.P.	1/4	1/4	1/4	1/4	1/4	1/3	1/3
Volts	115/60/1	115/60/1	115/60/1	115/60/1	115/60/1	115/60/1	115/60/1
Amps	6	6	6	6	6	7.5	7.5
NEMA	5-15P	5-15P	5-15P	5-15P	5-15P	5-15P	5-15P
Ship Wt.	293 lbs.	425 lbs.	513 lbs.	558 lbs.	631 lbs.	661 lbs.	734 lbs.

- Equipment shelf depth is 25" deep on 29" deep equipment.
- Equipment shelf depth is 29" deep on 33" deep equipment.
- Inside clearance = total unit length less 3"

ABS DRAWER PANS

Drawer Size	Removable Pan Size
18"	11" x 16" x 6"
24"	16" x 16" x 6"

* All models with adjustable and movable legs for 35 1/2" to 36 3/4" work height.

