



Custom Drawer Base Utility Stand models 12000

model 12318 12324 12336 12348 12360 12372

Description:

Drawer base utility stand with 16 gauge reinforced stainless top, and integral backsplash with 45° return. Self-closing dry storage drawers on 16 gauge tracks with 1 5/8" stainless bearings and removable plastic pans. 6" high adjustable and movable legs.

Specifications:

UNIT TOP: Top to be one piece of die formed 16 gauge stainless steel with 2 1/2" nosing. Backsplash to be covered cornered, with 45° return at top and overall height of 6 3/4". Ends at top fitted with recessed heavy duty steel bars for field bolting units together, producing a hairline seam. Top reinforced with (2) full length channel braces.

UNIT BODY: Body ends to be die formed stainless steel, finished and polished on the inside, with corrosion resistant exterior. Shelf to be 22 gauge stainless steel with marine edge at front, 6 5/8" removable covered cornered turn up at rear, and integrally welded channel bracing. Dry storage drawer(s) are located below shelf. Drawer pans are plastic, removable without tools, with drawer track of 16 gauge stainless steel with 1 5/8" stainless steel bearings, self-closing. Drawer front of 22 gauge stainless steel. Drawer track, pan(s) and front assembly contained in 20 gauge stainless steel housing. Legs to be 6" high stainless steel with adjustable bullet foot. Legs mounted to full length channel frame assembly which is integrally welded to bottom of body assembly. Legs can be moved left to right to avoid floor obstacles during installation.

NOTE: Multiple units may be built under a common top to get to longer lengths.

Standard Features:

- Available under one piece top with other modular equipment up to 16' in length
- 6" high legs—adjustable and movable
- Removable plastic pan(s) supplied for each self-closing drawer
- 45° integral stainless backsplash is standard. 90° stainless backsplash is optional.

Shown with optional finished end.



Options & Accessories:

- Additional drawers
- Urn trough
- Depth modification
- Casters

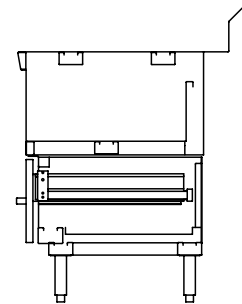
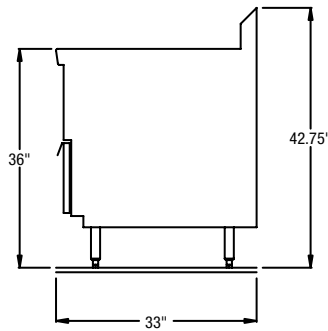
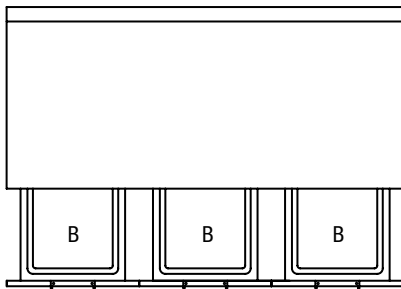
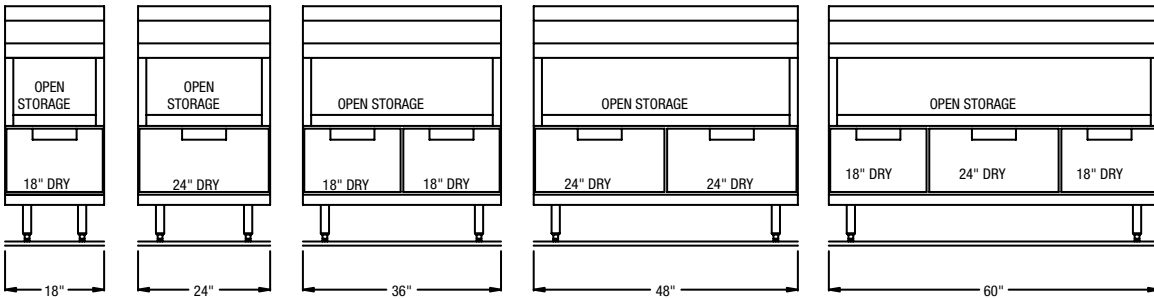

SECTION VIEW

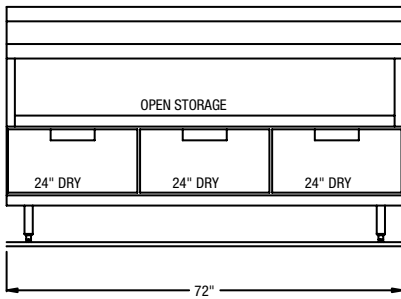

ABS DRAWER PANS

Drawer Size	Removable Pan Size
A 18"	11" x 16" x 6"
B 24"	16" x 16" x 6"

29" Deep Equipment						
Length	18"	24"	36"	48"	60"	72"
Height*	36"	36"	36"	36"	36"	36"
Drawers	(1) 18"	(1) 24"	(2) 18"	(2) 24"	(2) 18" (1) 24"	(3) 24"
Ship Wt.	152 lbs.	180 lbs.	236 lbs.	285 lbs.	334 lbs.	384 lbs.
33" Deep Equipment						
Length	18"	24"	36"	48"	60"	72"
Model No.	12318	12324	12336	12348	12360	12372
Height*	36"	36"	36"	36"	36"	36"
Drawers	(1) 18"	(1) 24"	(2) 18"	(2) 24"	(2) 18" (1) 24"	(3) 24"
Ship Wt.	152 lbs.	180 lbs.	236 lbs.	285 lbs.	334 lbs.	384 lbs.