



## Principal Features

- Easily handles all products including odd-shaped.
- Multi-lane capable.
- Base system can be enhanced with the integration of:
  - printing devices.
  - label applicators.
  - slip, tie and cap sheet insertion.
- Reprogrammable 4-axis FANUC robot delivering 78,000 hours meantime-between-failure reliability with custom designed end-of-arm-tooling.

## Applications

- Shrink-wrapped bundles.
- Cases, cartons, trays.
- Bags.
- Speciality items.
- Dissimilar product supply into common cell.



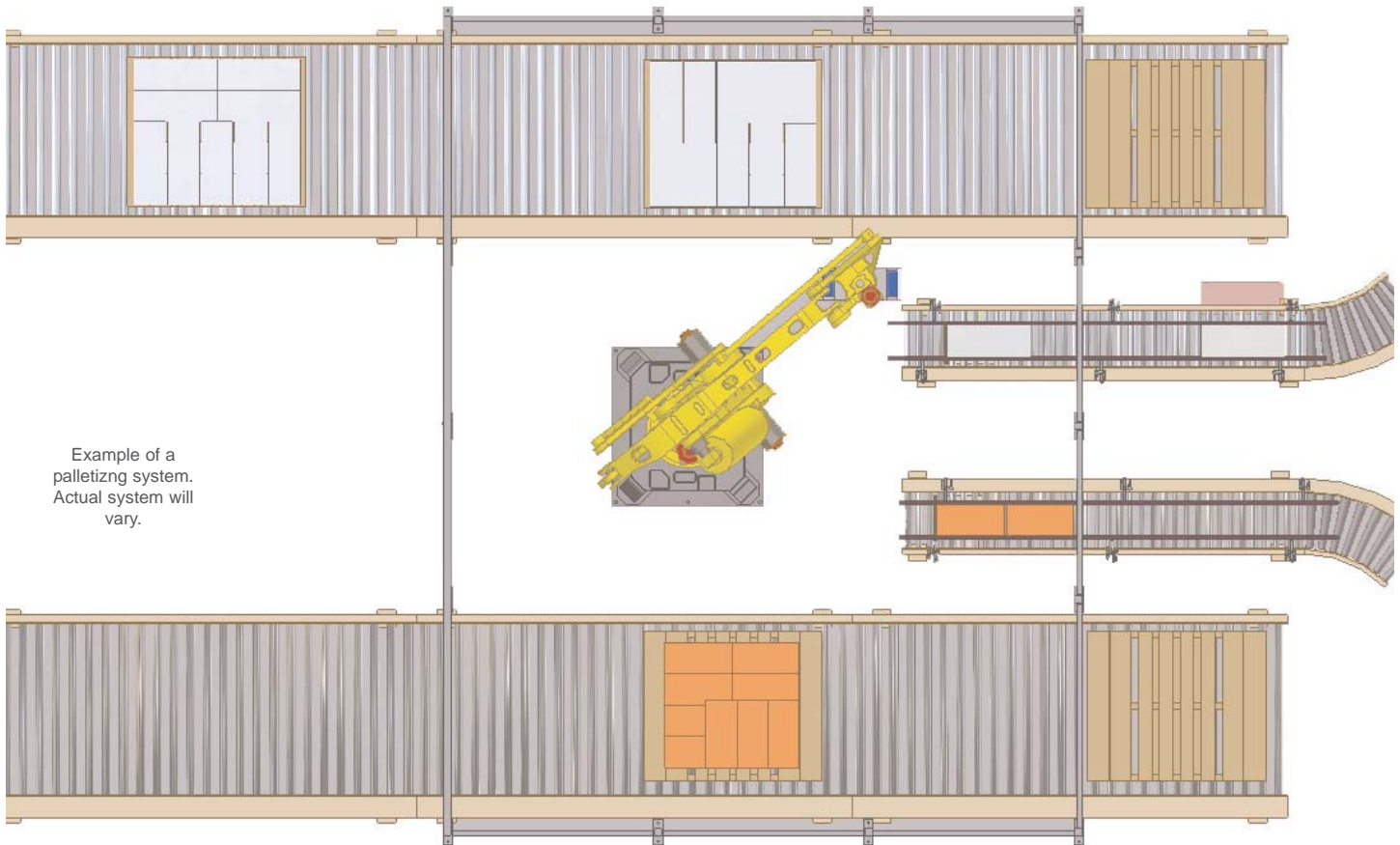

Example of a palletizing system. Actual system will vary.

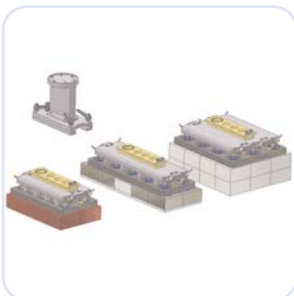

### Standard Features

- Product infeed module.
- Robotic loader.
- Pallet rack.
- Pallet infeed conveyor (one section).
- Full pallet discharge conveyor (one section).
- Category 3 compliant with electrically-interlocked wire mesh enclosure and access door.
- Low cost / time change parts.
- Collision guard.
- Easily programmed.
- Path optimization for gentle product handling and to improve load cycle time.

### Optional Features

- Label applicators.
- Automatic pallet magazine dispenser.
- Slip, tie and cap sheet insertion (dispenser or magazine).
- Stretch wrapper.
- Multiple infeeds and discharges.