

Twin tube intermittent motion vertical bag makers TG250 - LT and TG320-LDT

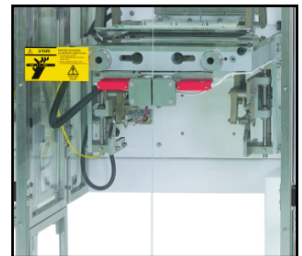
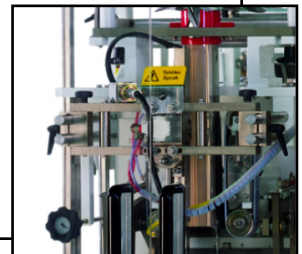

Features:

- **LT Models:** Clutch-brake film transport system and pneumatically-operated, intermittent motion cross seal jaws.
- **LDT Models:** Servo-driven film transport system and intermittent motion cross seal jaws.
- Allen Bradley control system with PanelView touch screen operator interface with choice of languages and access restriction feature.
- Simple menu-based rapid storage and retrieval function for 50 product recipes.
- Simple and fast bag size changeover with one-piece forming sets.
- Fully interlocked guarding system.
- Film reel runout device.
- Quick release, side-loading film reel air mandrel.
- Full configuration for polyethylene and/or heatseal materials.
- Independent temperature adjustment.
- Automatic out of tolerance monitoring for heatseal elements with instantaneous machine stoppage.
- Horizontal jaw obstruction detection, incorporating instantaneous machine stoppage.
- Friction drive film transport belts.
- Semi-automatic film tracking - LDT only and optional on LT.
- Stainless steel top tray - LDT only and optional on LT.
- Manual film splicing attachment - LDT only and optional on LT.
- Full synchronisation for printers*, labellers* and feed systems - LDT only and * optional on LT.

Barry-Wehmiller

Twin tube intermittent motion vertical bag makers

TG250 - LT and TG320-LDT

Dim	TG250-LT and LDT	TG320-LT and LDT
A	1266 (49.84)	1463 (57.59)
B	1458 (57.40)	1702 (67.00)
C	1812 (71.33)	1962 (77.24)
D	2073 (81.61)	2073 (81.61)
E	1982 (78.03)	2282 (89.84)
F	709 (31.10)	940 (37.00)
G	1670 (65.74)	1858 (71.13)

Dimensions in mm with equivalent inches in brackets (for guidance only).

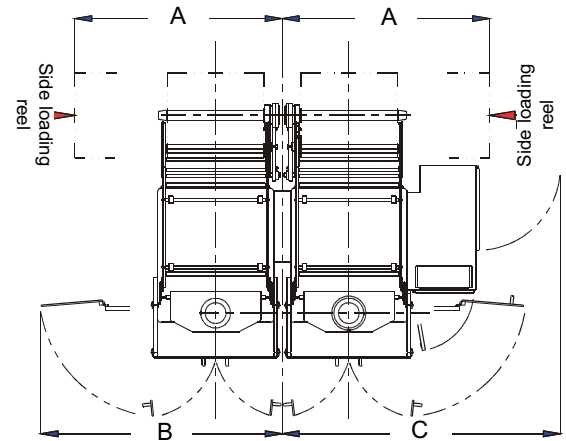

Technical Data

All information given below is dependent upon final machine specification, feed arrangement, product type and film specification.

Power Requirement

(20 Amp, 3-phase neutral and earth) 7KVA.

Operating Pressure

5.8 bar (85 lbs/sqin) (minimum).

Air Consumption (based on 60 bags/min.)

Heatseal:

LDT Models - 282 litres/min (8 cu.ft/min).

LT Models - 1,410 litres/min (40 cu.ft/min).

DigiPoly:

LDT Models - 1,552 litres/min (44 cu.ft/min).

LT Models - 2,680 litres/min (76 cu.ft/min).

Weight

TG250 Models - 1,800kg (4,078lb).

TG320 Models - 1,950kg (4,298lb).

Bag Size (width)

TG250 Models - 60mm minimum/250mm maximum on pillow pack (2.3 to 9.8in).

TG320 Models - 80mm minimum/320mm maximum on pillow pack (3.1 to 12.6in).

Bag Size (length)

TG250 Models - Up to 400mm on a single pull (15.7in).

TG320 Models - Up to 500mm on a single pull (19.7in).

Output

TG250 Models - up to 90 bags/minute.

TG320 Models - up to 80 bags/minute.

Reel Mandrel

Core Diameter: Most sizes accommodated.

Outside Diameter: maximum 600mm (23.62in).

Weight/Mandrel (side-loading): 50kg (110lb) for single and 35kg (77lb)/reel for twin.

Drop-on mandrels recommended above these weights.

Optional Features

- Left or right hand positioning of the electrical control cabinet.
- Left or right hand positioning of the operator interface panel, irrespective of cabinet position.

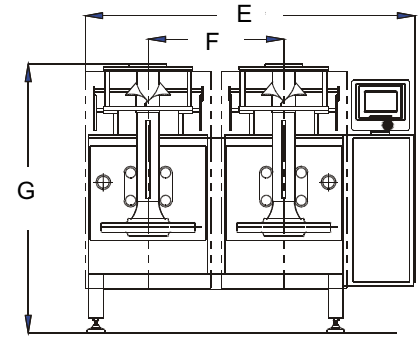
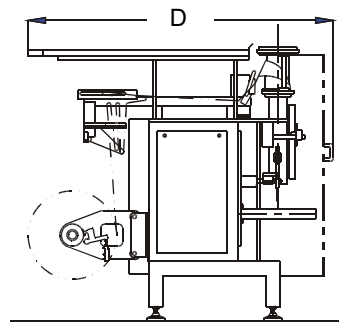

- Fully enclosed stainless steel or painted mild steel construction.
- Stainless steel top tray (standard on LDT and optional on LT).
- Single or twin side-loading or drop-on, air operated film reel mandrels.
- Heatseal and/or DigiPoly (impulse weld) horizontal cross seal jaws and vertical backseal.
- Vacuum assisted belt-driven film transport.
- Semi-automatic film tracking control (standard on LDT and optional on LT).
- Fully-automatic film tracking control.
- Early tip hopper.
- Gas flushing.
- Static eliminator.
- Voltage surge protection.
- Full bag take-off elevator.
- Full bag rotary take-off table.
- Block bottom and/or gusset.
- Powered film reel unwind unit.
- Synchronisation for printer or labeller (standard on LDT and optional on LT).
- Film reel runout advance warning.
- Film splicing attachment (standard on LDT and optional on LT).
- Metal detection.
- Forming set inner tubes.
- Printer.
- Labeller.
- Bag clip attachment.
- Bag metering.
- Bag shaker.
- Bag support and discharge unit.
- Bag vibrator and discharge unit.
- Bag deflator.
- Servo film transport system (standard on LDT and optional on LT).
- Ethernet connection for MIS/SCADA systems.
- Additional powered nip drive unit - only available with servo transport system.
- Transverse zip applicator (optional on LDT or on LT with optional servo-driven transport system).
- Jaw Options:
 - nick knife.
 - gusset bag.
 - block bottom.
 - date coding.
 - strip pack.
 - punch hole.
 - carrier bag handle.
 - heated Euroslot.
- Snack Options:
 - product catchers.
 - infeed poker.
 - bag stripper.
- Single tube versions available (reference TG250-LD, TG320-LD and TG320-LD).

HayssenSandiacre

USA - 225 Spartangreen Boulevard • Duncan, SC 29334 USA • 864/486-4000

UNITED KINGDOM - 16 Roman Way • Thetford, Norfolk IP24 1XB United Kingdom • +44 (0) 1842 754171

UNITED KINGDOM - 101 Lilac Grove • Beeston, Nottingham, NG9 1PF • United Kingdom • +44 (0) 115 967 8

MEXICO - Castorena 324-118 • Cuajimalpa • 05000 México, D.F. • +(52-55)5813-7770

www.hayssensandiacre.com • sales@hayssensandiacre.com