

ROSE FORGROVE Flow Wrapper Merlin HSE

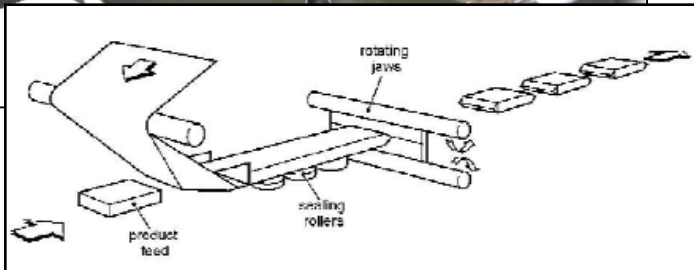

Features:

■ Flexible and Dependable

- Standard and higher speed versions available to meet varying requirements (see tables over leaf)
- Ability to handle 160mm (6.3in) high products for optimum flexibility
- Multi-axis servo drives
- PC or PLC architecture with colour monitor
- Colour touch screen operator interface

■ Hygienic

- Designed for fast clean down and changeover
- All product contact parts manufactured from stainless steel or food grade plastic

■ Reduced Setup Times

- Quick and easy product size change for minimum downtime
- Quick change infeed lugs or paddles
- Low level film reel mounting

■ Reduced Waste

- 'No product-no bag' feature keeps film waste to a minimum

- 'Misplaced product detection' eliminates product damage and avoids jams - not available with carry over unit

■ Control Features

- Storage and retrieval of up to 100 product recipes
- Parameter adjustment under all conditions including on-the-fly
- Three axis servo system
- Smart belt ready
- Axes remain synchronised until power off or complete product change
- Real time diagnostics, machine test facility and hidden engineering functions
- Integral temperature controllers

Barry-Wehmiller

ROSE FOREGROVE Flow Wrapper Merlin HSE

Dim	
A	1500 (59.05)
B	1878 (73.93)
C	330 (12.99)
D	900 (35.43)
E	439 (17.28)
F	4160 (163.77)
Dimensions in mm with equivalent inches in brackets	

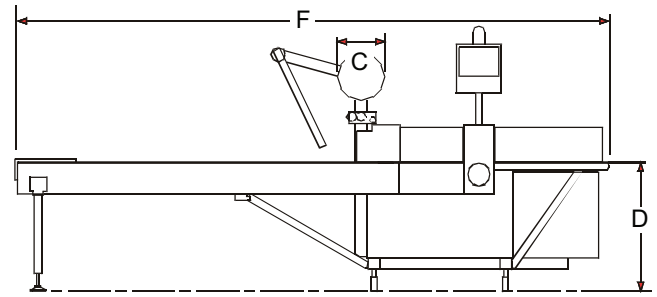
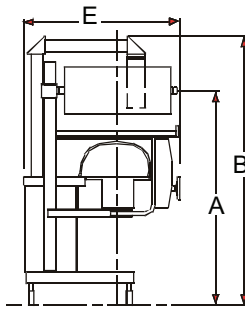

Technical Data

All information given below is dependent upon final machine specification, feed arrangement, product type, options selected and film specification.

Electric Supply and Consumption

400V, 3-phase 50 cycles plus neutral and earth.

Up to 25 amps/phase.

Operating Pressure

5.6bar (80lbs/sqin) (minimum).

Air Consumption

Minimal and dependent upon options selected.

Environmental Conditions

Ambient temperature range: 0 to 40 degrees Celsius (104 degrees Fahrenheit).

Humidity: 0 to 80% non-condensing.

Standard sealing: IP54.

Weight

1,200kg (2,640b).

Reel Mandrel

Core: 76mm (3in).

Outside Diameter: maximum 330mm (13in).

Weight/Mandrel: 25kg (55lb).

Wrapping materials

Suitable coated cellulose films; heat-sealable lacquered materials; coated polypropylene; co-extrusion and plastics laminated to paper; film or foil. Cold films can also be used.

Standard Features

- Driven wrapper pre-feed.
- Single reel mounting.
- Pack tight/loose control.
- 2m (78.75in) infeed with single infeed pitch on a multi-pitch chain.
- Crimp release handwheel.
- Adjustment for crimp height.
- Crimp overload clutch.
- Simple, easy-to-use operator control panel.
- Individual temperature controls for top crimp, bottom crimp and long seam rollers.
- Electronic adjustment of cut-off length and crimp dwell.
- Electronic speed control.
- Operator changeable fixed folding box.

- Simple, tool-free product size change.
- Wipedown finish.
- All product contact parts in stainless steel or food quality plastic.
- Designed and manufactured to comply with European machinery directives and British Standard BS 5304:1988.
- Automatic opening of the heated long seam rollers.
- Status and management statistics.

Optional Features

- Twin reel twin-film reel mounting.
- Reel runout sensor.
- Coding unit.
- Automatic feed systems.
- Discharge pack reject station.
- Simple, adjustable folding box.
- Additional pair of heated long seal rollers.
- Stainless steel version.
- Stainless steel infeed and/or guards.
- Right hand configuration.
- Adjustable folding box.
- Machine castors.
- Photo-electric cell wrapper registration.
- Infeed extensions in 1.2m (47.24in) increments.
- Lipped infeed side guides.
- Product on lug sensor.
- Product carrying slats.
- Twin jaw option: 100, 130, 150mm centres.
- Pack gussetting unit.
- Crimp carry over unit for small products.
- Euroslot crimp jaws.
- Heated cleft in long seam unit.
- Water cooled deadplates.
- 1m (39.37in) discharge extension.
- Labellers (various).
- Proprietary coding units.
- Additional positional stop push-button.
- Discharge extension.
- Feeder Signal - ancillary machine running.

Single Jaw Machine	Single Jaw Size Range mm (in)					
	100 (3.90)	130 (5.15)	130 (5.15)	150 (5.90)	180 (7.1)	180H (7.1)
Crimp centres	100 (3.90)	130 (5.15)	130 (5.15)	150 (5.90)	180 (7.1)	180H (7.1)
Max. product height	50 (2.00)	75 (3.00) +	75 (3.30) +	95 (3.70) +	120 (4.70)	170 (6.70) +
Max. product length	270 (10.60)	373 (14.70)	373 (14.70)	433 (17.00)	528 (20.78)	528 (20.8)
Max. product width	150 (5.90)	150 (5.90)	300 (11.80)	300 (11.80)	300 (11.80)	300 (11.80) #
Wrapper cut-off	70 - 315 (2.75 - 12.40)	102 - 410 (4.01 - 16.10)	102 - 410 (4.01 - 16.10)	117 - 470 (4.60 - 18.50)	140 - 565 (5.51 - 22.20)	140 - 565 (5.5 - 22.20)
Maximum wrapper width	450 (17.70)	450 (17.70)	750 (29.50)	750 (29.50)	750 (29.50)	750 (29.50)
Speed without carry over	20 - 175	20 - 150	20 - 100	20 - 100	20 - 70	20 - 70
Speed with carry over	N/A	20 - 70	20 - 70	20 - 70	20 - 70	20 - 70
+ If crimp carry over unit is fitted the height acceptance is reduced by 10mm (0.39).						
# Maximum product width for products from 120mm up to 170mm (4.7 to 6.7) high is 200mm (7.9).						

Twin Jaw Machine	Twin Jaw Size Range mm (in)			
	100 (3.90)	130 (5.15)	130 (5.15)	150 (5.90)
Crimp centres	100 (3.90)	130 (5.15)	130 (5.15)	150 (5.90)
Max. product height	50 (2.00)	75 (3.00)	75 (3.00)	95 (3.75)
Max. product length	135 (5.30)	185 (7.35)	185 (7.35)	217 (8.50)
Max. product width	150 (5.90)	150 (5.90)	200 (7.80)	200 (7.80)
Wrapper cut-off	70 - 157 (2.75 - 6.20)	102 - 205 (4.01 - 8.50)	102 - 205 (4.01 - 8.50)	117 - 235 (4.60 - 9.25)
Maximum wrapper width	450 (17.70)	450 (17.70)	750 (29.50)	750 (29.50)
Speed without carry over	20 - 250	20 - 250	20 - 250	20 - 200

HayssenSandiacre

USA - 225 Spartangreen Boulevard • Duncan, SC 29334 USA • 864/486-4000

UNITED KINGDOM - 16 Roman Way • Thetford, Norfolk IP24 1XB United Kingdom • + 44 (0) 1842 754171

UNITED KINGDOM - 101 Lilac Grove • Beeston, Nottingham, NG9 1PF • United Kingdom • +44 (0) 115 967 8787

MEXICO - Castorena 324-118 • Cuajimalpa • 05000 México, D.F • +(52-55)5813-7770

www.hayssensandiacre.com • sales@hayssensandiacre.com