

Circulation and Supply Pumps

With NXT™ Technology

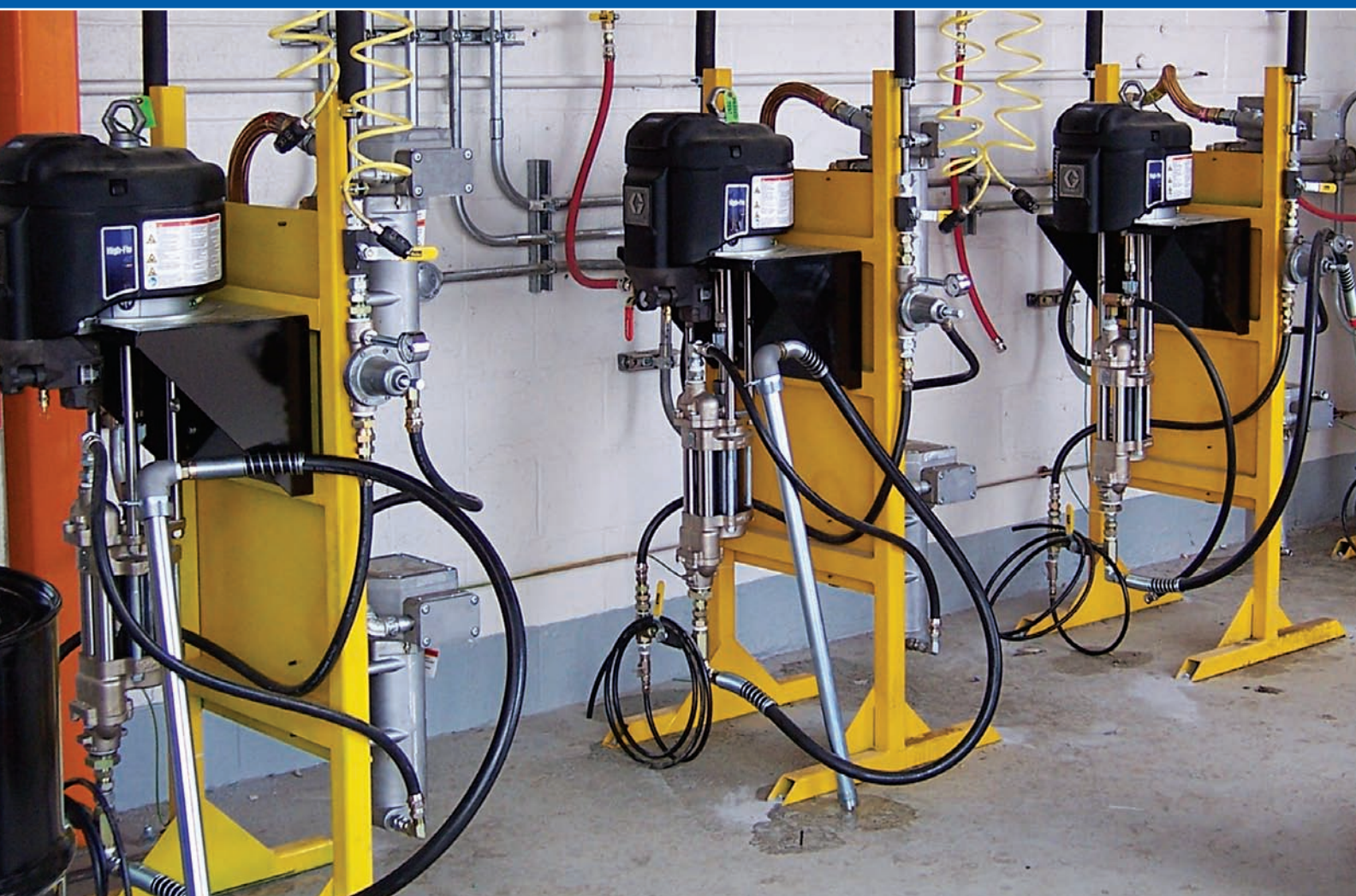

Setting a New Industry Standard!

- Tested to outperform other pumps on the market with a long-life packing design
- Provides material tracking, system diagnostics and runaway control with DataTrak™, the market's first integrated local monitoring system
- Offers positive displacement, 2-ball and 4-ball piston designs for uniform and easily controlled delivery
- Easily handles a broad range of paints and coatings
- Designed for improved serviceability with fewer parts, faster repairs and lower cost of ownership

PROVEN QUALITY. LEADING TECHNOLOGY.

Discover the Next Generation of Power and Performance

New NXT Air Motor Technology Lasts up to 10 Times Longer!

We've taken the best and made it even better. With the NXT air motor, you get a new pump that sets a higher standard for long-lasting durability. In fact, the NXT air motor is proven to last 10 times longer than its predecessors, the Graco Senator®, Bulldog® and King. Built to handle the toughest finishing applications, the NXT also provides easy access to its integrated air controls and de-icing feature, plus it reduces noise. And with more models and configurations to choose from, you get the precise pressure and output you need for your high performance applications.

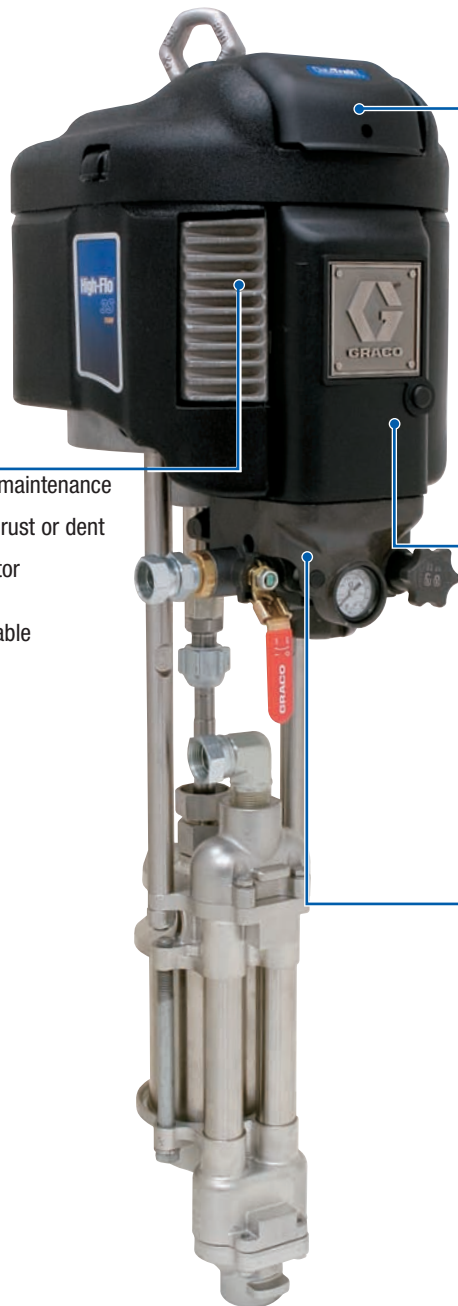

NEW NXT Air Motor

- Modular design for easier maintenance
- Rugged body armor won't rust or dent
- Highest technology air motor on the market
- Three exhaust styles available
 - Low noise
 - Remote
 - De-Icing

Optional NEW DataTrak™ Control

- Runaway protection
- Pump diagnostics
- Material usage



NEW Modular Air Valve

- De-icing controls standard
- Up to 50% quieter than previous models
- Modular air valve
 - Eliminates stalling
 - Easy-to-repair



Optional NEW Integrated Air Controls

- Lockable easy-turn regulator
- Front-mounted for convenient access
- Compact and modular
- Built-in filtration



What's NXT?

Innovation that boosts your productivity.

Graco NXT. It's what's next.

Raising the Bar for High-Performance Circulation and Supply

Less Pulsation for Better Results

NXT technology provides a smooth, rapid changeover for a better, more consistent finish and less user fatigue.

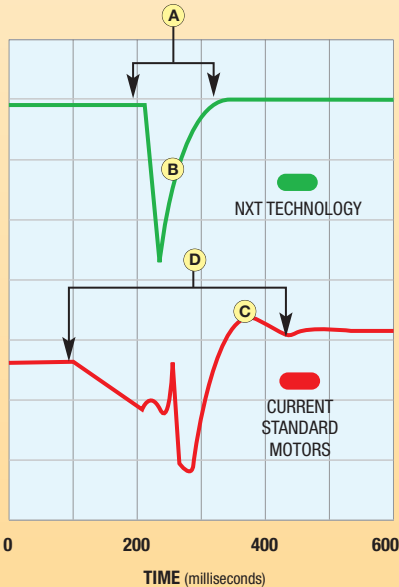

- A** Less than $\frac{1}{15}$ of a second changeover!
- B** Quick changeover and recovery with less pulsation
- C** Pressure spike at changeover
- D** Longer changeover causing pulsation

Noise-Reduction Technology

The quiet, low-noise NXT air motor operates around 87 decibels, while other comparable motors operate up to 103 dB(A).

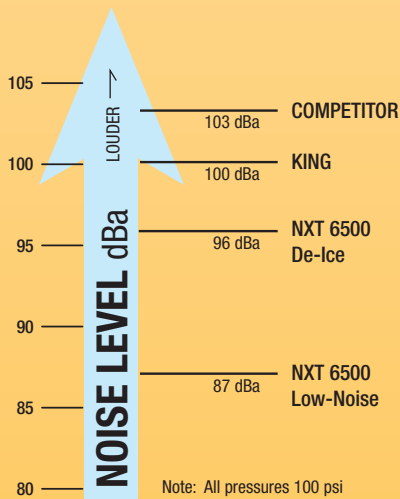

Features and Benefits

Increased Reliability

The new NXT Air Motor is proven to last 10 times longer than the Graco Senator, Bulldog and King.

That means you get longer lasting reliable performance when you upgrade your standard pump to the new NXT versions.

New NXT Air Motor

Graco King

10x
Longer!

In Graco testing, the Graco King resulted in 4 million cycles MTBF (mean time before failure), while the new NXT resulted in 40 million cycles MTBF.

Easy Maintenance

Graco air motors are designed with modular components so that no special tools are needed for assembly and repair.

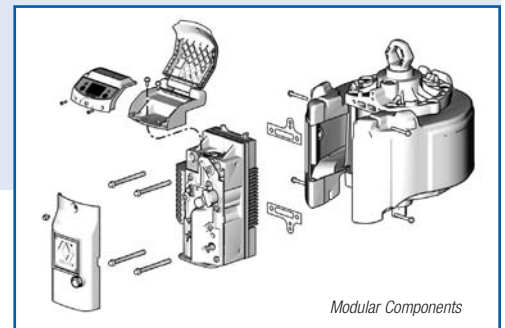

Reduced Icing

All new NXT Air Motors come standard with Graco's new de-icing technology. The Active De-Icing Control allows the operator to add warmer ambient air to the motor to melt any build-up of frost or ice.

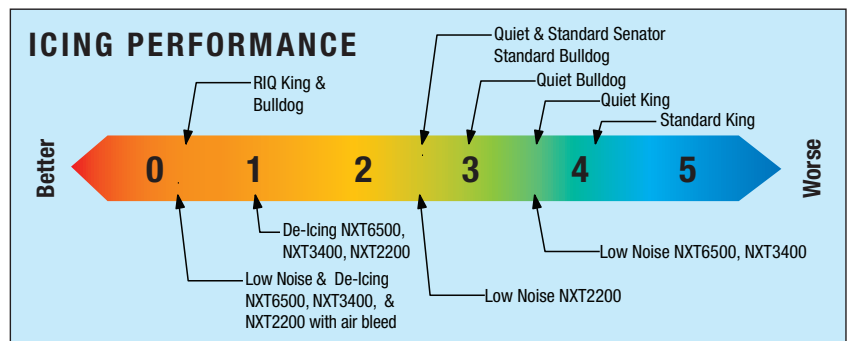

| 15:1 | 16:1 | 21:1 | 23:1 | 24:1 | 25:1 | 30:1 | 31:1 | 32:1 | 40:1 | 45:1 | 46:1 |
|----------------|-----------------|-----------------|-----------------|-----------------|-----------------|-----------------|-----------------|-----------------|-----------------|-----------------|-----------------|
| 430cc | 290cc | 220cc | 580cc | 180cc | 290cc | 220cc | 145cc | 530cc | 180cc | 290cc | 145cc |
| NXT 3400 | NXT 2200 | NXT 2200 | NXT 6500 | NXT 2200 | NXT 3400 | NXT 3400 | NXT 2200 | NXT 6500 | NXT 3400 | NXT 6500 | NXT 3400 |
| 1580 (109) | 1520 (104.8) | 2030 (140.0) | 2270 (156.5) | 2430 (167.5) | 2380 (164.1) | 3170 (218.6) | 3040 (209.6) | 3030 (208.9) | 3800 (262.0) | 4550 (313.7) | 4750 (327.5) |
| 100 (6.9) | 100 (6.9) | 100 (6.9) | 100 (6.9) | 100 (6.9) | 100 (6.9) | 100 (6.9) | 100 (6.9) | 100 (6.9) | 100 (6.9) | 100 (6.9) | 100 (6.9) |
| 6.9 (26.1) | 4.6 (17.5) | 3.4 (12.9) | 9.2 (34.8) | 2.9 (11.0) | 4.6 (17.5) | 3.4 (12.9) | 2.3 (8.8) | 6.9 (26.1) | 2.9 (11.0) | 4.6 (17.5) | 2.3 (8.8) |
| 311826 | 311164 | 311164 | 311826 | 311164 | 311164 | 311164 | 311164 | 311826 | n/a | n/a | n/a |
| 311826 | 311828 | 311828 | 311826 | 311828 | 311828 | 311828 | 311828 | 311826 | 311828 | 311828 | 311828 |
| 311825 | 311762 | 311762 | 311825 | 311762 | 311762 | 311762 | 311762 | 311825 | n/a | n/a | n/a |
| 311825 | 311827 | 311827 | 311825 | 311827 | 311827 | 311827 | 311827 | 311825 | 311827 | 311827 | 311827 |
| 311238 | 311238 | 311238 | 311238 | 311238 | 311238 | 311238 | 311238 | 311238 | 311238 | 311238 | 311238 |
| 2" npt (f) | 1 1/4" npt(m) | 1 1/4" npt(m) | 2" npt (f) | 1 1/4" npt(m) | 1 1/4" npt(m) | 1 1/4" npt(m) | 1 1/4" npt(m) | 2" npt (f) | n/a | n/a | n/a |
| 1 1/2" npt (f) | 1" npt (f) | 1" npt (f) | 1 1/2" npt (f) | 3/4" npt (f) | 1" npt (f) | 1" npt (f) | 3/4" npt (f) | 1 1/2" npt (f) | n/a | n/a | n/a |
| 2" npt (f) | 2" npt (f) | 2" npt (f) | 2" npt (f) | 1 1/2" npt (f) | 2" npt (f) | 2" npt (f) | 1 1/2" npt (f) | 2" npt (f) | 1 1/2" npt (f) | 2" npt (f) | 1 1/2" npt (f) |
| 1 1/2" npt (m) | 1" npt (f) | 1" npt (f) | 1 1/2" npt (m) | 3/4" npt (f) | 1" npt (f) | 1" npt (f) | 3/4" npt (f) | 1 1/2" npt (m) | 3/4" npt (f) | 1" npt (f) | 3/4" npt (f) |

| 15:1 | 16:1 | 21:1 | 23:1 | 24:1 | 25:1 | 30:1 | 31:1 | 32:1 | 40:1 | 45:1 | 46:1 |
|--------|--------|--------|--------|--------|--------|--------|--------|---------|--------|--------|--------|
| P15DCD | P16DC1 | P21DC1 | P23DCD | P24DC1 | P25DC1 | P30DC1 | P31DC1 | P32DCD | | | |
| P15ECD | P16EC1 | P21EC1 | P23ECD | P24EC1 | P25EC1 | P30EC1 | P31EC1 | P32ECD | | | |
| P15LCD | P16LC1 | P21LC1 | P23LCD | P24LC1 | P25LC1 | P30LC1 | P31LC1 | P32LCD | | | |
| P15MCD | P16MC1 | P21MC1 | P23MCD | P24MC1 | P25MC1 | P30MC1 | P31MC1 | P32MCD | | | |
| P15DSB | | | P23DSA | | | | | P32DSB | | | |
| | P16DSE | P21DSE | | P24DSE | P25DSE | P30DSE | | | P40DSE | P45DSE | |
| | | | P23ESA | | | | P31DSH | | | | P46DSH |
| P15ESB | P16ESE | P21ESE | | P24ESE | P25ESE | P30ESE | | P32ESB | P40ESE | P45ESE | |
| | | | | | | | P31ESH | | | | P46ESH |
| P15LSB | | | P23LSA | | | | | P32LSB | | | |
| | P16LSE | P21LSE | | P24LSE | P25LSE | P30LSE | | | P40LSE | P45LSE | |
| | | | | | | | P31LSH | | | | P46LSH |
| P15MSB | | | P23MSA | | | | | P32MSBI | | | |
| | P16MSE | P21MSE | | P24MSE | P25MSE | P30MSE | | | P40MSE | P45MSE | |
| | | | | | | | P31MSH | | | | P46MSH |

Graco recommends 20 cpm or less for supply applications and 12 cpm or less for circulation applications.

Selecting the Right Pump

Eight Models to Fit all of Your Demanding Applications

High-Flo® and High-Flo Plus Pumps

| | | 2:1 | 3:1 | 3.3:1 | 3.5:1 | 4:1 | 4.4:1 | 4.5:1 | 6:1 | |
|-----------------------------------|----------------------------|---|----------------|--------------|----------------|----------------|--------------|----------------|--------------|--------------|
| HIGH-FLO AND HIGH-FLO PLUS | PUMP SPECIFICATIONS | Output per cycle | 2000cc | 1500cc | 4000cc | 2000cc | 1000cc | 3000cc | 1500cc | 2000cc |
| | | Motor Size | NXT 2200 | NXT 2200 | NXT 6500 | NXT 3400 | NXT 2200 | NXT 6500 | NXT 3400 | NXT 6500 |
| | | Maximum Working Pressure psi (bar, Mpa) | 200 (13.8) | 290 (20) | 325 (22.5) | 340 (23.5) | 400 (27.6) | 460 (31.8) | 450 (31.1) | 500 (34.5) |
| | | Maximum Air Input Pressure psi (bar, Mpa) | 100 (6.9) | 100 (6.9) | 100 (6.9) | 100 (6.9) | 100 (6.9) | 100 (6.9) | 100 (6.9) | 78 (5.4) |
| | | Output at 60 CPM gpm (lpm) | 31.9 (119.3) | 23.2 (87.9) | 63 (238.6) | 31.5 (119.3) | 16.9 (64) | 47.3 (179) | 23.2 (87.9) | 31.5 (119.3) |
| | MANUALS | Pump Manual | 311211 | 311211 | 311831 | 311211 | 311211 | 311831 | 311211 | 311831 |
| | | Lower Manual | 311690 | 311690 | 311832 | 311690 | 311690 | 311832 | 311690 | 311832 |
| | | Motor Manual | 311238 | 311238 | 311238 | 311238 | 311238 | 311238 | 311238 | 311238 |
| | INLET/OUTLET SIZE | CS Pump Inlet Size | 1.5" npt (f) | 1.5" npt (f) | 2" npt (f) | 1.5" npt (f) | 1.5" npt (f) | 2" npt (f) | 1.5" npt (f) | 2" npt (f) |
| | | CS Pump Outlet Size | 1" npt (f) | 1" npt (f) | 2" npt (f) | 1" npt (f) | 1" npt (f) | 2" npt (f) | 1" npt (f) | 2" npt (f) |
| SST Pump Inlet Size | | 1.5" npt (f) | 1.5" npt (f) | 2" npt (f) | 1.5" npt (f) | 1.5" npt (f) | 2" npt (f) | 1.5" npt (f) | 2" npt (f) | |
| SST Pump Outlet Size | | 1" npt (f) | 1" npt (f) | 2" npt (f) | 1" npt (f) | 1" npt (f) | 2" npt (f) | 1" npt (f) | 2" npt (f) | |
| SST Pump Inlet Size | | 1.5" BSPP (f) | 1.5" BSPP (f) | 2" BSPP (f) | 1.5" BSPP (f) | 1.5" BSPP (f) | 2" BSPP (f) | 1.5" BSPP (f) | 2" BSPP (f) | |
| SST Pump Outlet Size | | 1.25" BSPP (f) | 1.25" BSPP (f) | 2" BSPP (f) | 1.25" BSPP (f) | 1.25" BSPP (f) | 2" BSPP (f) | 1.25" BSPP (f) | 2" BSPP (f) | |
| SST Pump Inlet Size | | 2" Tri-Clamp | 2" Tri-Clamp | N/A | 2" Tri-Clamp | 2" Tri-Clamp | N/A | 2" Tri-Clamp | N/A | |
| SST Pump Outlet Size | 2" Tri-Clamp | 2" Tri-Clamp | N/A | 2" Tri-Clamp | 2" Tri-Clamp | N/A | 2" Tri-Clamp | N/A | | |

| | | MOTOR TYPE | DATATRAK INCLUDED | FITTINGS/LOWER MATERIALS | 2:1 | 3:1 | 3.3:1 | 3.5:1 | 4:1 | 4.4:1 | 4.5:1 | 6:1 | |
|--------------------------|----------------------------|------------|-------------------|--------------------------|--------|--------|--------|--------|--------|--------|--------|--------|--------|
| PUMP CONSTRUCTION | CARBON STEEL (C) | L | 1 | JC20L1 | | | JC33L1 | JC35L1 | | JC44L1 | | JC60L1 | |
| | | L | 7 | | JC30L7 | | | | JC40L7 | | JC45L7 | | |
| | | M | Yes | 1 | JC20M1 | | | JC33M1 | JC35M1 | | JC44M1 | | JC60M1 |
| | | M | Yes | 7 | | JC30M7 | | | | JC40M7 | | JC45M7 | |
| | STAINLESS STEEL (S) | L | 1 | JS20L1 | JS30L1 | JS33L1 | JS35L1 | JS40L1 | JS44L1 | JS45L1 | JS60L1 | | |
| | | L | 2 | JS20L2 | JS30L2 | | JS35L2 | JS40L2 | | JS45L2 | | | |
| | | L | 3 | JS20L3 | JS30L3 | JS33L3 | JS35L3 | JS40L3 | JS44L3 | JS45L3 | JS60L3 | | |
| | | L | 4 | JS20L4 | JS30L4 | | JS35L4 | JS40L4 | | JS45L4 | | | |
| | | L | 5 | JS20L5 | JS30L5 | | JS35L5 | JS40L5 | | JS45L5 | | | |
| | | L | 6 | JS20L6 | JS30L6 | | JS35L6 | JS40L6 | | JS45L6 | | | |
| | | M | Yes | 1 | JS20M1 | JS30M1 | JS33M1 | JS35M1 | JS40M1 | JS44M1 | JS45M1 | JS60M1 | |
| | | M | Yes | 2 | JS20M2 | JS30M2 | | JS35M2 | JS40M2 | | JS45M2 | | |
| | | M | Yes | 3 | JS20M3 | JS30M3 | JS33M3 | JS35M3 | JS40M3 | JS44M3 | JS45M3 | JS60M3 | |
| | | M | Yes | 4 | JS20M4 | JS30M4 | | JS35M4 | JS40M4 | | JS45M4 | | |
| | | M | Yes | 5 | JS20M5 | JS30M5 | | JS35M5 | JS40M5 | | JS45M5 | | |
| | | M | Yes | 6 | JS20M6 | JS30M6 | | JS35M6 | JS40M6 | | JS45M6 | | |
| | | R | 1 | JS20R1 | JS30R1 | JS33R1 | JS35R1 | JS40R1 | JS44R1 | JS45R1 | JS60R1 | | |
| | | R | 2 | JS20R2 | JS30R2 | | JS35R2 | JS40R2 | | JS45R2 | | | |
| | | R | 3 | JS20R3 | JS30R3 | JS33R3 | JS35R3 | JS40R3 | JS44R3 | JS45R3 | JS60R3 | | |
| | | R | 4 | JS20R4 | JS30R4 | | JS35R4 | JS40R4 | | JS45R4 | | | |
| | | R | 5 | JS20R5 | JS30R5 | | JS35R5 | JS40R5 | | JS45R5 | | | |
| | | R | 6 | JS20R6 | JS30R6 | | JS35R6 | JS40R6 | | JS45R6 | | | |
| | | S | Yes | 1 | JS20S1 | JS30S1 | JS33S1 | JS35S1 | JS40S1 | JS44S1 | JS45S1 | JS60S1 | |
| | | S | Yes | 2 | JS20S2 | JS30S2 | | JS35S2 | JS40S2 | | JS45S2 | | |
| | | S | Yes | 3 | JS20S3 | JS30S3 | JS33S3 | JS35S3 | JS40S3 | JS44S3 | JS45S3 | JS60S3 | |
| | | S | Yes | 4 | JS20S4 | JS30S4 | | JS35S4 | JS40S4 | | JS45S4 | | |
| | | S | Yes | 5 | JS20S5 | JS30S5 | | JS35S5 | JS40S5 | | JS45S5 | | |
| | | S | Yes | 6 | JS20S6 | JS30S6 | | JS35S6 | JS40S6 | | JS45S6 | | |

Graco recommends 20 cpm or less for supply applications and 12 cpm or less for circulation applications.

