

# HS/HSSprimus - Technical Data

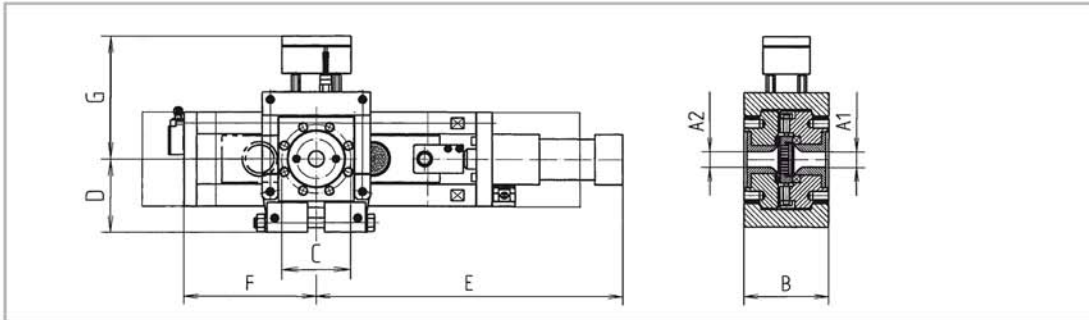

## Technical Data HSprimus

filter type	screen area in cm <sup>2</sup>	heating capacity in watt	heater zones	pressure in bar max. <sup>(1)</sup>	dimensions in mm							weight in kg	
					A1 / A2 (max.) <sup>(1)</sup>	B	C <sup>(2)</sup>		D	E	F		G
HSprimus 20	5	920	1	800	20	120	75	(4xM12)	70	475	215	130	50
HSprimus 30	10	920	1	800	30	139	110	(4xM16)	120	500	215	260	50
HSprimus 45	20	1020	1	800	45	139	110	(4xM16)	120	560	290	260	60
HSprimus 60	35	1400	1	800	60	164	120	(8xM12)	130	650	300	275	75
HSprimus 75	50	2800	1	800	75	204	140	(8xM20)	155	800	305	290	120
HSprimus 90	70	3000	1	800	90	229	155	(8xM20)	160	880	390	325	170
HSprimus 110	105	4600	2	800	110	264	225	(8xM24)	200	1000	405	360	280
HSprimus 130	145	5840	2	500	130	284	245	(8xM24)	210	1050	460	380	370
HSprimus 150	195	8000	2	500	150	324,5	285	(8xM24)	250	1150	565	400	600
HSprimus 180	285	10000	2	300	180	374	295	(8xM30)	260	1400	625	420	1000
HSprimus 220	415	11200	2	250	220	450	370	(12xM30)	300	1550	685	450	1400
HSprimus 270	615	12500	2	200	270	550	455	(12xM36)	380	1800	800	520	2200
HSprimus 320	855	15600	2	200	320	600	530	(12xM36)	420	1880	870	560	3500

## Technical Data HSSprimus

filter type	screen area in cm <sup>2</sup>	heating capacity in watt	heater zones	pressure in bar max. <sup>(1)</sup>	dimensions in mm							weight in kg	
					A1 / A2 (max.) <sup>(1)</sup>	B	C <sup>(2)</sup>		D	E	F		G
HSSprimus 20	10	1600	1	450	20	183	75	(4xM12)	150	590	280	260	90
HSSprimus 30	20	1600	1	350	30	183	110	(4xM16)	150	590	280	260	90
HSSprimus 45	40	1600	1	350	45	183	110	(4xM16)	150	590	280	260	100
HSSprimus 60	70	2400	1	350	60	192	120	(8xM16)	165	740	310	275	140
HSSprimus 75	110	3400	1	300	75	220	140	(8xM20)	185	730	350	290	165
HSSprimus 90	150	4000	2	300	90	230	155	(8xM20)	210	880	450	325	220
HSSprimus 110	225	5600	2	300	110	260	200	(8xM24)	245	980	480	360	310
HSSprimus 130	310	7200	2	250	130	300	220	(8xM24)	260	1195	600	400	460
HSSprimus 150	425	9500	2	250	150	330	250	(8xM30)	290	1350	750	430	700
HSSprimus 180	625	12800	2	250	180	380	295	(8xM30)	300	1750	800	450	1200

(1) = Diameter individually adjustable.

(2) = Diameter.