

# SD-300 Dough Divider



Glimek SD-300 is an automatic suction-feed dough divider which can be used either as 1-pocket or 2-pocket. The strong construction of the SD-300 is adapted to continuous trouble free use.

# SD-300 Dough Divider



PLC control including a touch screen with menu based system including speed in pcs/h, piece counting, preset counting, fine tune of the belts and a reference scale for the weight. Separate control for outfeed belt.



Easy to switch from 1-pocket to a 2-pocket.



Dough knife in stainless steel direct connected to the hopper provides an optimal emptying of the hopper.

The dividing mechanism from high quality Ni-resistant steel ensures a high weight accuracy.

Oilreservoir 3 US gal, easy to fill.

## Accessories

Flour duster, mechanical	Flour duster on the first conveyor, mechanical
Hopper 59.5 US gal	Dough Hopper 59.5 US gal, approximately 330 bl dough (Standard is 26.4 US gal, 154 bl dough)
Hopper lubrication for 59.5 US gal hopper	Automatic lubrication inside the dough hopper, by means of a spread tube system
Non-stick coating of hopper 26.4 US gal	Interior of the dough hopper 26.4 US gal non-stick to assure a smooth infeed of the dough
Non-stick coating of hopper 59.5 US gal	Interior of the dough hopper US gal non-stick to assure a smooth infeed of the dough
Oiling of belt	Oiling device for oiling the first conveyor belt
Special belt	Special customized belt on one or both conveyors
Non stick coating dough scraper	Non-stick dough scraper to ensure clean deposit of sticky dough on the conveyor
Transfer roller	Support driven roller at the end of the outfeed conveyor, for sticky dough

## Technical data

Capacity range	
2-pocket	1500 - 3000 dough pieces/hour
1-pocket	750 - 1500 dough pieces/hour
Weight range	
2-pocket SD-300	1.4 - 14.1 oz
1-pocket SD-300	3.5 - 35.3 oz
2-pocket SD-300 XL	5.3 - 40.6 oz
1-pocket SD-300 XL	8.8 - 81.3 oz
Power Supply	1.62 kW
Weight, net	1510 lb
Weight, gross (carton+pallet)	1642 lb
Volume, gross	160 ft <sup>3</sup>
dB(A)	73

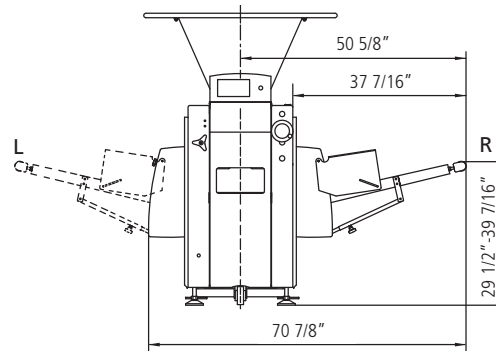
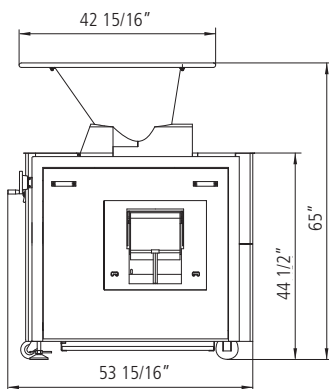

Left (L) or right (R) outfeed has to be specified by order



**Glimek AB**  
 Box 124  
 S-280 64 GLIMÅKRA  
 Sweden  
 Tel. int. +46-(0)44 449 00 • Fax +46-(0)44 449 10  
 e-mail: office@glimek.se • www.glimek.se



Belshaw Adamatic Bakery Group  
 814 44th St NW  
 Suite 103  
 Auburn Washington 98001  
 USA  
 Phone: +1 732 544 8400  
 Fax: +1 732 544 0735