

IPP-Pocket Proofer Industrial



Glimek's IPP Industrial Pocket Proofer is constructed as a modular system to accommodate customer's specified capacity and proofing times. The IPP-Industrial is equipped with a dual infeed system loading 2 pcs each time and with a capacity up to 3000 pcs/hr. Frame, swings and covers are made of stainless steel.



Sveba Dahlen Group



IPP-Pocket Proofer Industrial



Non-stick coated transferbox as standard assures an interference free production



Pockets made of nylon mesh, easy to remove for cleaning, weight range 3.50 - 53 oz

The dual infeed V-belt conveyors up to 3000 pcs/h is one of three infeed systems. Non-stick coated flap system loads 2 pcs each time



Electrical control panel with all controls for the proofer easily accessible

Electrical sockets provided on the electrical cabinet for power supply to and normal shutdown of divider, rounder and moulder

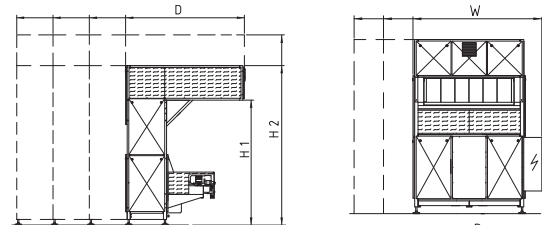

Accessories

Infeed chute up to 1200 pcs/h (standard)	Proofer runs intermittently
Single infeed V-belt up to 1800 pcs/h	Photocell controlled with continuous prover drive. Can be mounted left/right on front or backside of prover
Double infeed V-belts up to 3000 pcs/h	Photocell controlled with continuous prover drive Mounted in front and center of the prover Flap system feed the prover 2 pcs each time Compressed air is required
Collection drawers 6, 8 or 10 rows	Under the prover, for easy cleaning
Electrical control panel	Separate control panel under overhead projection with all controls for the prover
Electrical sockets for divider, rounder and moulder	Sockets on the electrical cabinet to provide power supply to, and common shut down of, divider, rounder and moulder
Guiding plates, non-stick	Guiding the dough piece at the receiving swing, for very elastic dough pieces
Heating fan	Thermostat controlled fan
Humidification system, automatic	Hygrostat and thermostat controlled system Self-contained. 1/4" water supply
Outfeed cross conveyor for single infeed provers 6, 8 or 10 rows with height extension. For capacity up to 1800 pcs/h	Mounted under the outlet of the pocket prover, width = 13 1/16". Also available reversible for feeding in two directions
Outfeed cross conveyor for double infeed provers 8 or 10 rows with height extension. For capacity up to 3000 pcs/h	Mounted under the outlet of the pocket prover, frequency controlled, width = 13 1/16" Also available reversible for feeding in two directions
Outlet sliding plate covering the 3 last flaps.	Mounted under the outlet of the pocket prover, sliding the dough piece to hopper or table. Non-stick coated
Synchronized speed with dough divider	Synchronized speed between the dough divider (master) and a prover with infeed conveyor Divider has to be ordered together with the prover
Ultraviolet lighting	UV-light to protect against moisture and mould

Technical data

Infeed systems	3 versions (see accessories)
Capacity range	max. 3000 pcs/h
Weight range	3.5 oz - 3.3 lb
Power supply	0.60 kW (min)
Air supply (double infeed)	6 bar
Number of effective pockets	132-940

Measurements	W	D	H1	H2
6 pockets	6' 5"	6' 4"	6' 8 5/16"	8' 6 3/8"
8 pockets	7' 9 1/2"	6' 4"	6' 8 5/16"	8' 6 3/8"
10 pockets	9' 2"	6' 4"	6' 8 5/16"	8' 6 3/8"
Extra module		+ 23 15/64"		
Height extension module			+ 19 11/16"	+ 19 11/16"

Total pockets net			Swings net	Back modules	Height extension
Pockets /swing					
6	8	10			
132	176	220	22		
156	208	260	26		yes
240	320	400	40	1	
288	384	480	48	1	yes
360	480	600	60	2	
432	576	720	72	2	yes
468	624	780	78	3	
564	752	940	94	3	yes

When ordering define pockets/swing and swings net, f.ex. IPP 10/48

Infeed side left, right, front or back must be specified by order.
 Pls communicate delivery size.



Glimek AB
 Box 124
 S-280 64 GLIMÄKRA
 Sweden
 Tel. int. +46-(0)44 449 00 • Fax +46-(0)44 449 10
 e-mail: office@glimek.se • www.glimek.se



Belshaw Adamatic Bakery Group
 814 44th St NW
 Suite 103
 Auburn Washington 98001
 USA
 Phone: +1 732 544 8400
 Fax: +1 732 544 0735