



Control according to PAT results

FETTE
COMPACTING

High containment now also on high-productivity double sided rotary presses – FETTE 3090i WiP Containment

Containment is becoming more and more important to pharmaceutical production. The 2090i WiP Containment, the first standard press to be fitted out in this way, was presented at the lastACHEMA. The first double sided rotary press to be set up for containment is now available in the 3090i WiP Containment.

The press combines the advantages of the high-productivity double sided rotary press technology with WiP technology – and now with containment equipment too – in a standard solution. The result is that containment can be managed easily by any potential user. The necessary components, the isolators, the WiP-compatible peripheral devices, the product supply and discharge equipment are all in use on the 2090i WiP Containment, and have already been proven in practice on the 3090i WiP Containment.

- A guaranteed OEL (Occupational Exposure Limit) of 0.1 µg/m³ averaged over 8 hours of production
 - a lower OEL can be achieved with certain products
- The compression compartment is dustproof and water-tight
 - no dust contamination can escape
- 8 large glove ports at three window flaps
 - the whole compression compartment can be reached manually without operator exposure
- The WiP Center supplies all the washing equipment in the press, in the isolators and in the peripheral units

inside them

- no manipulation from outside is needed for washing
- Double seals on the glove ports
 - for glove exchange without contamination
- Material fed in through an isolation valve system
 - the material container can be attached and removed with complete freedom from contamination
- RTP integrated into the window flap as an interface for the tablet discharge to the isolator
 - secure, encapsulated product discharge
- A second RTP acts as a material lock for introducing and removing tools and samples
 - safe handling under operational conditions
- Air management for all the air flowing in the unit, which operates under partial vacuum
 - high safety provided by filtering the exhaust air through a FETTE ABSOLUT filter unit
 - protects the air supply system from contamination in the event of vacuum failure
- Inflatable window flap seals
 - secure sealing
- Rotary separator (patent pending) in the isolator used as by-pass during drum exchange
 - by-pass time adjustable via parameter 301
 - tablets cannot get stuck
 - increased process reliability
 - easy cleaning

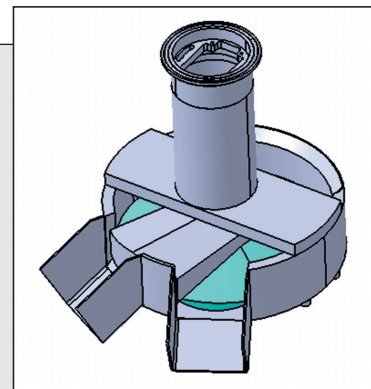

- See the FETTE 3090i WiP brochure for the latest yield figures and machine data.

FETTE GMBH
Grabauer Str. 24 · D-21493 Schwarzenbek
Tel.: +49 (0) 41 51 12-0 · Fax: +49 (0) 41 51 83 33 71
E-mail: tablet@fette.com · Internet: <http://www.fette.com>

Packaging - Processing
Bid on Equipment
1-847-683-7720
www.bid-on-equipment.com