

Can Seaming & Manufacturing Machine



MODEL

10P

Rated Speed up to

85 CPM



- ▶ Easy Maintenance and Operation
- ▶ No Can/No Cover Feed
- ▶ Reciprocating Cover Separator Knife
- ▶ Embossing Type Cover Marker
- ▶ Wide Range of Accessories and Attachments
- ▶ Topper Unit (optional)
- ▶ Complete Change Parts, including Bronze and Stainless Steel
- ▶ Filler Drive with Safety Clutch
- ▶ Filler/Seamer Connections
- ▶ Variable Speed Motor Drive
- ▶ Modification for Oil Filters Available

Standard Features



Tool Kit & Instruction Manual



Head Spin Machine

Optional Features



Titanium Nitride-Coated Chromium Cobalt Seaming Rolls



Ceramic Seaming Roll Bearings



Steam Vacuum



Under Cover Gassing



Can Manufacturing

Technical Specifications

MODEL

10P

No. of Seaming Heads	1	Nombre stations sertis.	Anz. Verschluss-Stat.	Num. de Cabezas de Doble Cierre	1
Output Speed Range	30-85 CPM	Gamme vitesse poss.	Mögl.Geschw.Bereich	Vol. De Producción	30-85 CPM
Min./Max. Can Diameter	202-404	Diam.boîte min./max.	Min./Max. Dosendurchm.	Diámetro Mín./Máx. del Envase	54.0mm-108.0mm
Min./Max. Can Diameter (Optional)	108-404	Diam.boîte min./max. (Option.)	Min./Max. Dosendurchm. (Option.)	Diámetro Mín./Máx. del Envase (Opcional)	38.1mm-108.0mm
Min./Max. Can Height	108-708	Hauteur boîte min./max.	Min./Max. Dosenhöhe	Altura Mín./Máx. del Envase	38.1mm-190.5mm
Min./Max. Can Height (Optional)	108-1000	Hauteur boîte min./max. (Option.)	Min./Max. Dosenhöhe (Option.)	Altura Mín./Máx. del Envase (Opcional)	38.1mm-254.0mm
Min./Max. Can Height (SV)	111-700	Hauteur boîte min./max. (Vapeur)	Min./Max. Dosenhöhe (Bedampf.)	Altura Mín./Máx. del Envase (Vacio al Vapor)	42.9mm-177.8mm
Transfer Chain Pitch Can Centers	Random	Pas de chaîne transfert (distance entre boîtes)	Dosentransferketten-Teilung	Centros de la Cadena de Transferencia	Random
Horsepower/Electrical	3-5 Hp	Kw-Force électr.	Kw-Elektroleistung	Hp/Eléctrica	2-4 Kw
Electrical Controls	24 Volt DC	Commandes électr.	Elektrosteuerung	Control Eléctrico	24 Volt DC
Steam Supply	330°F @ 60 psi	Provision de Vapeur	Dämpfen Sie Versorgung	El Suministro del Vapor	165°C @ 4 bars
Net Weight (Approx.)	2,000 lbs	Poids net (Approx.)	Nettogewicht (ca.)	Peso Neto (Aprox.)	907 Kg
Gross Weight Domestic (Approx.)	2,700 lbs	Poids Brut - Transport intérieur (Approx.)	Bruttogewicht - Inland Verkehr (ca.)	Peso Bruto - Doméstico (Aprox.)	1,225 Kg
Gross Weight Export (Approx.)	3,000 lbs	Poids Brut - Exportation (Approx.)	Bruttogewicht - Export (ca.)	Peso Bruto - Exportación (Aprox.)	1,360 Kg

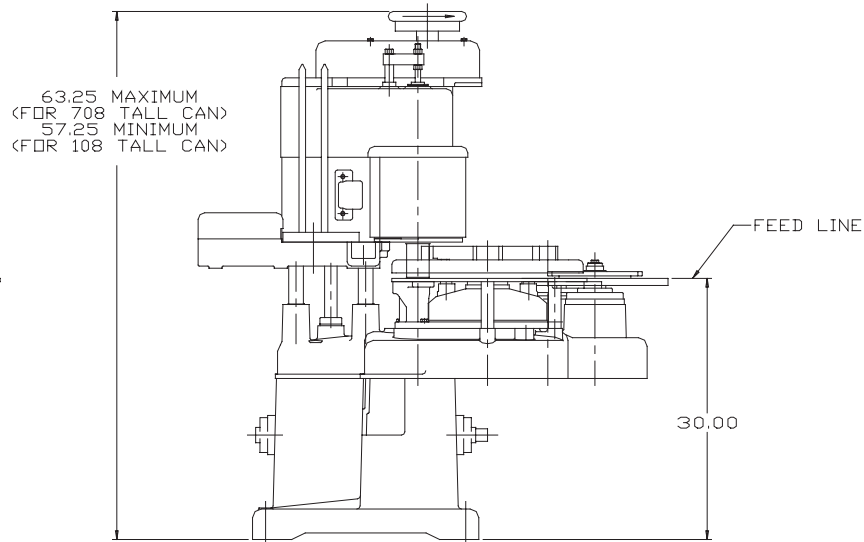
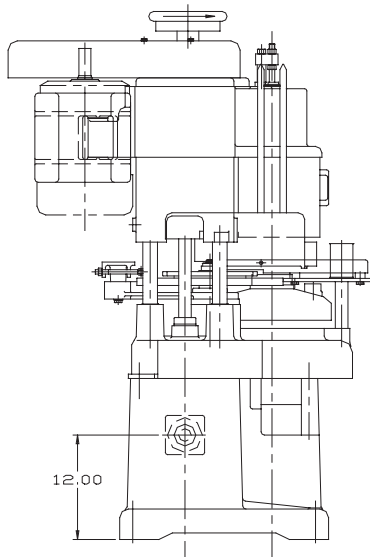
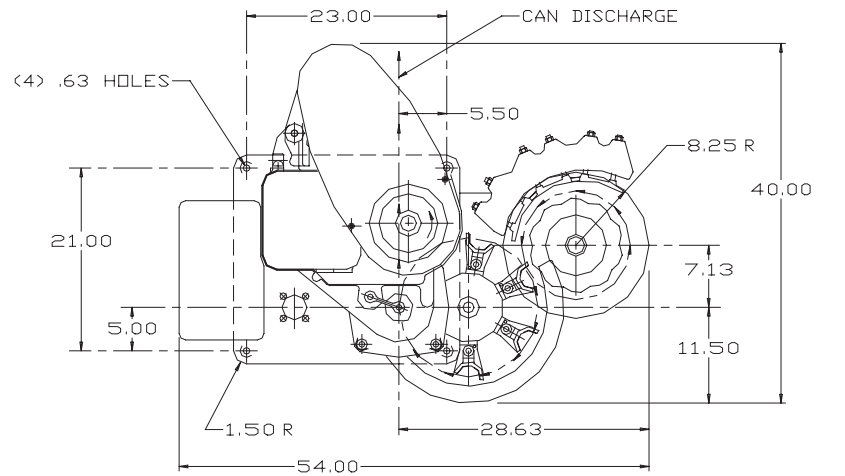

Packaging - Processing
Bid on Equipment
 1-847-683-7720
 www.bid-on-equipment.com

ANGELUS SANITARY CAN MACHINE COMPANY
 4900 PACIFIC BOULEVARD, LOS ANGELES, CA 90058 (323) 583-2171 FAX: (323) 587-5607
 WEBSITE: www.angelusmachine.com E-MAIL: angelus@angelusmachine.com

ANGELUS MACHINE CORPORATION INTERNATIONAL
 BELGIUM OFFICE: BELCROWNLAAN 44, B-2100 DEURNE, BELGIUM (32) 3 325.69.20 FAX: (32) 3 325.56.33
 DE'SALIS DRIVE, HAMPTON LOVETT IND. EST., DROITWICH, WORCS. WR9 0QE, U.K. 44 (0) 1905 779602 FAX: 44 (0) 1905 771882

